

KOKUSAI KI-76 'STELLA'

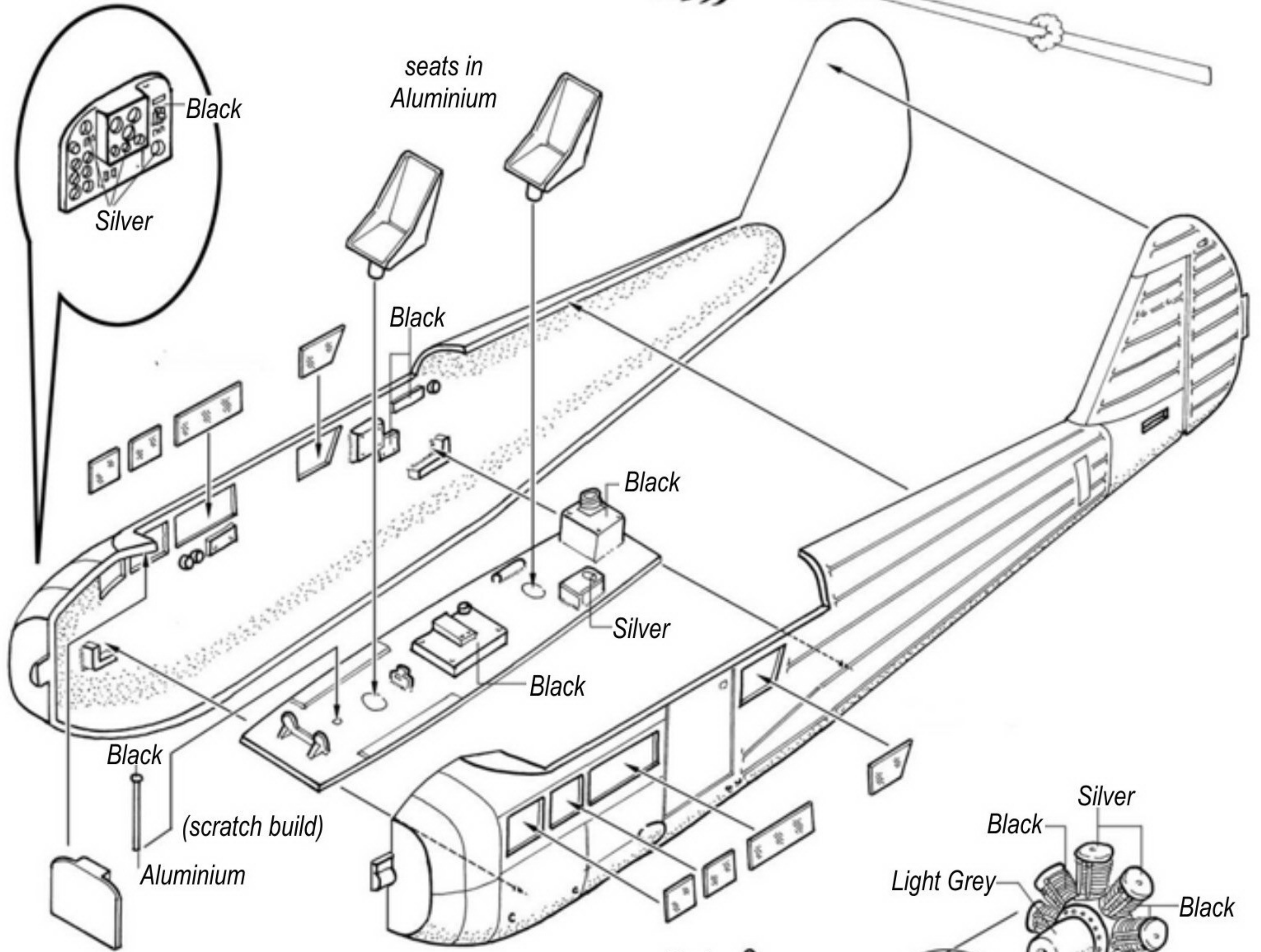

Cockpit interior colours:
 the cockpit interior, controls, etc., were painted
 in Japanese Interior Green. The instrument panel was Black.

Assembly instructions

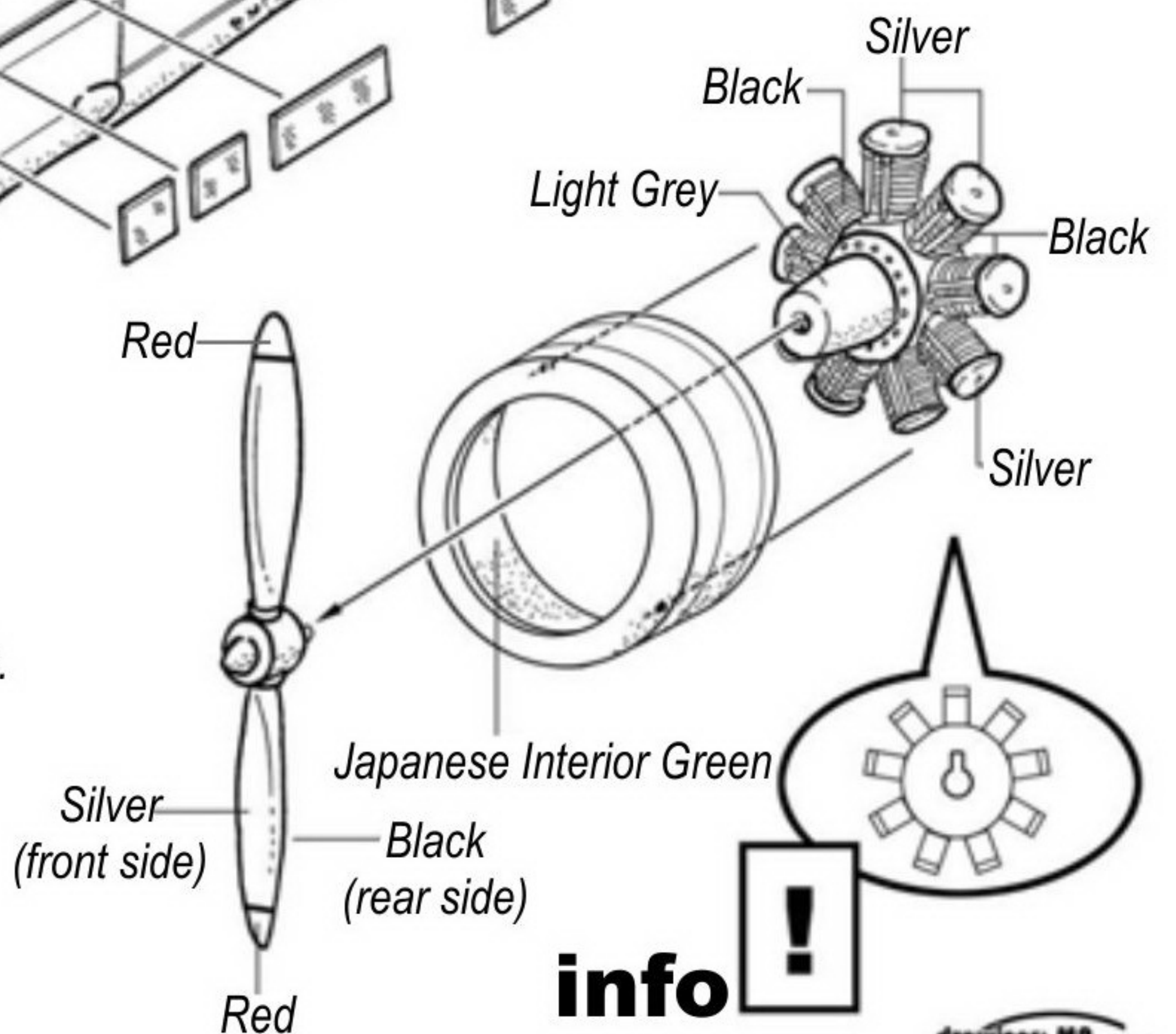

info !

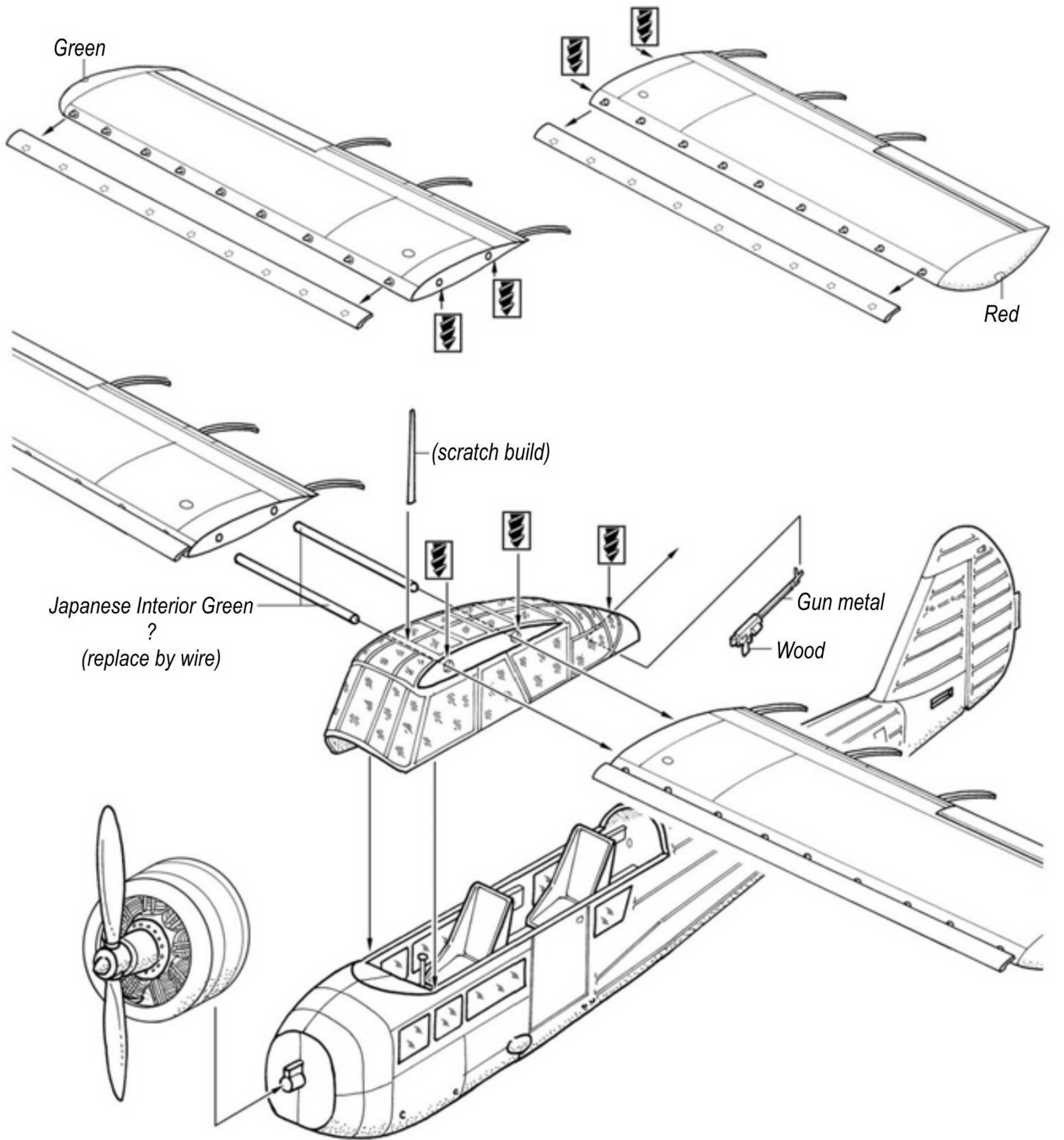

info

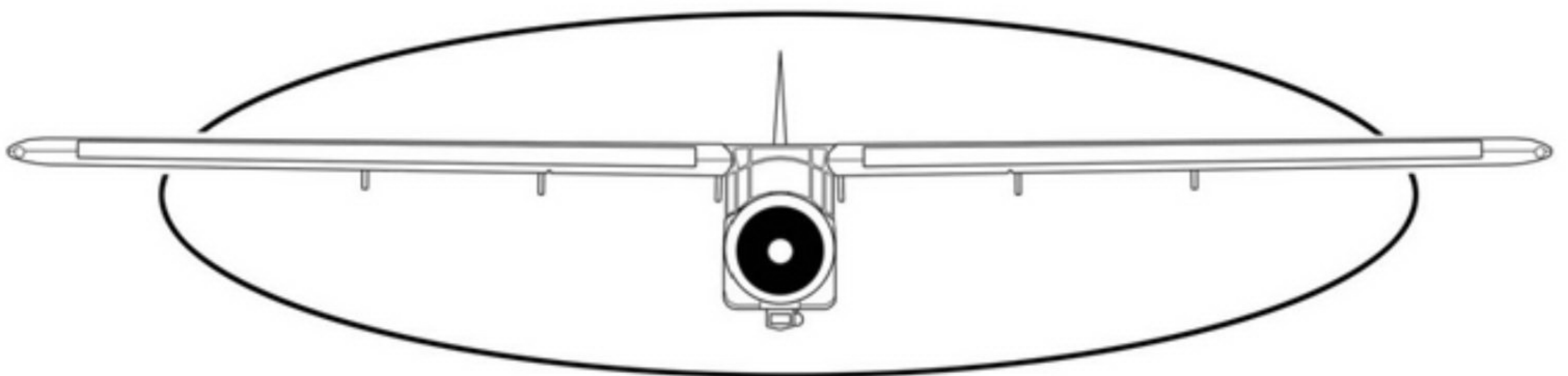

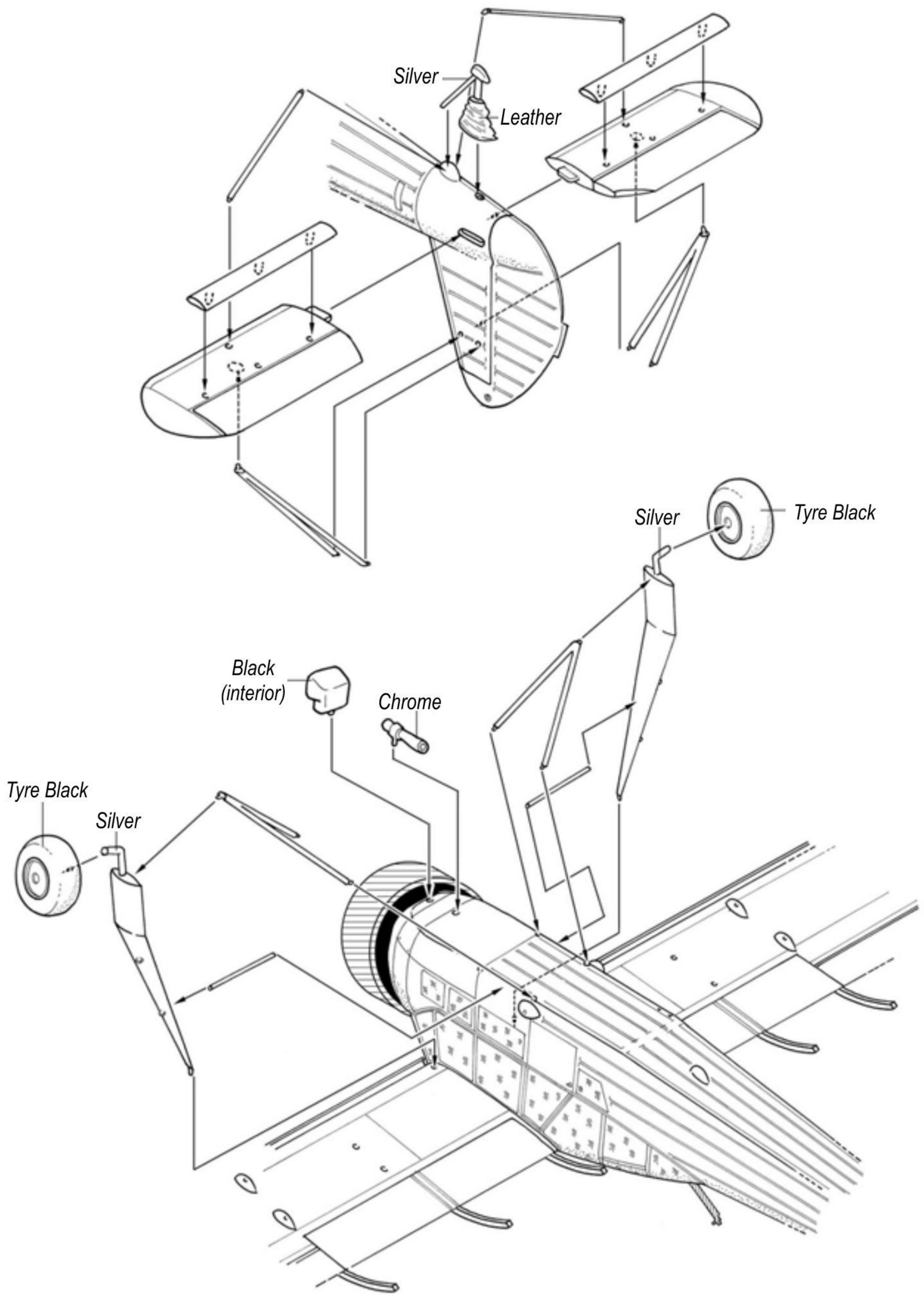

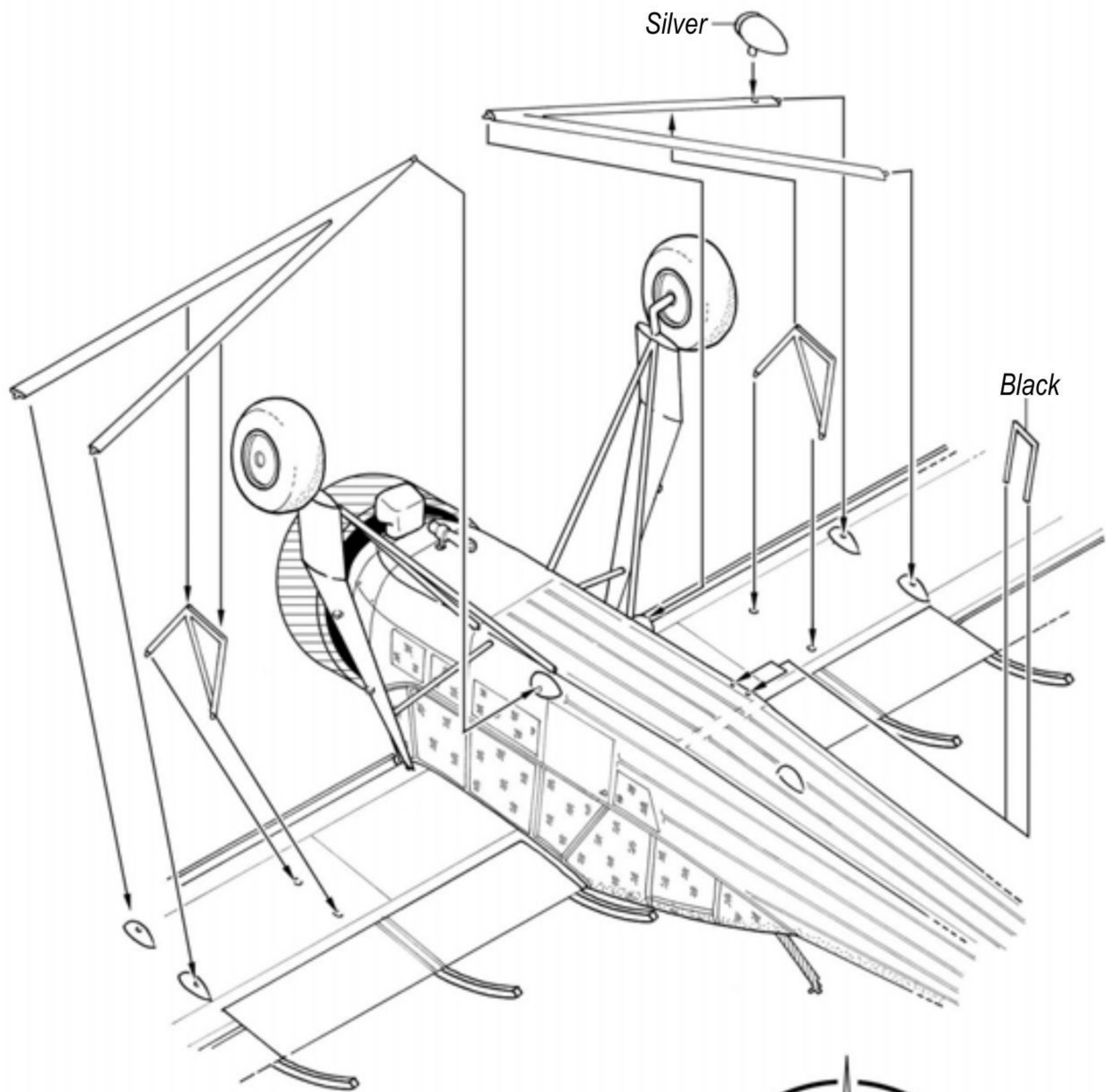

info

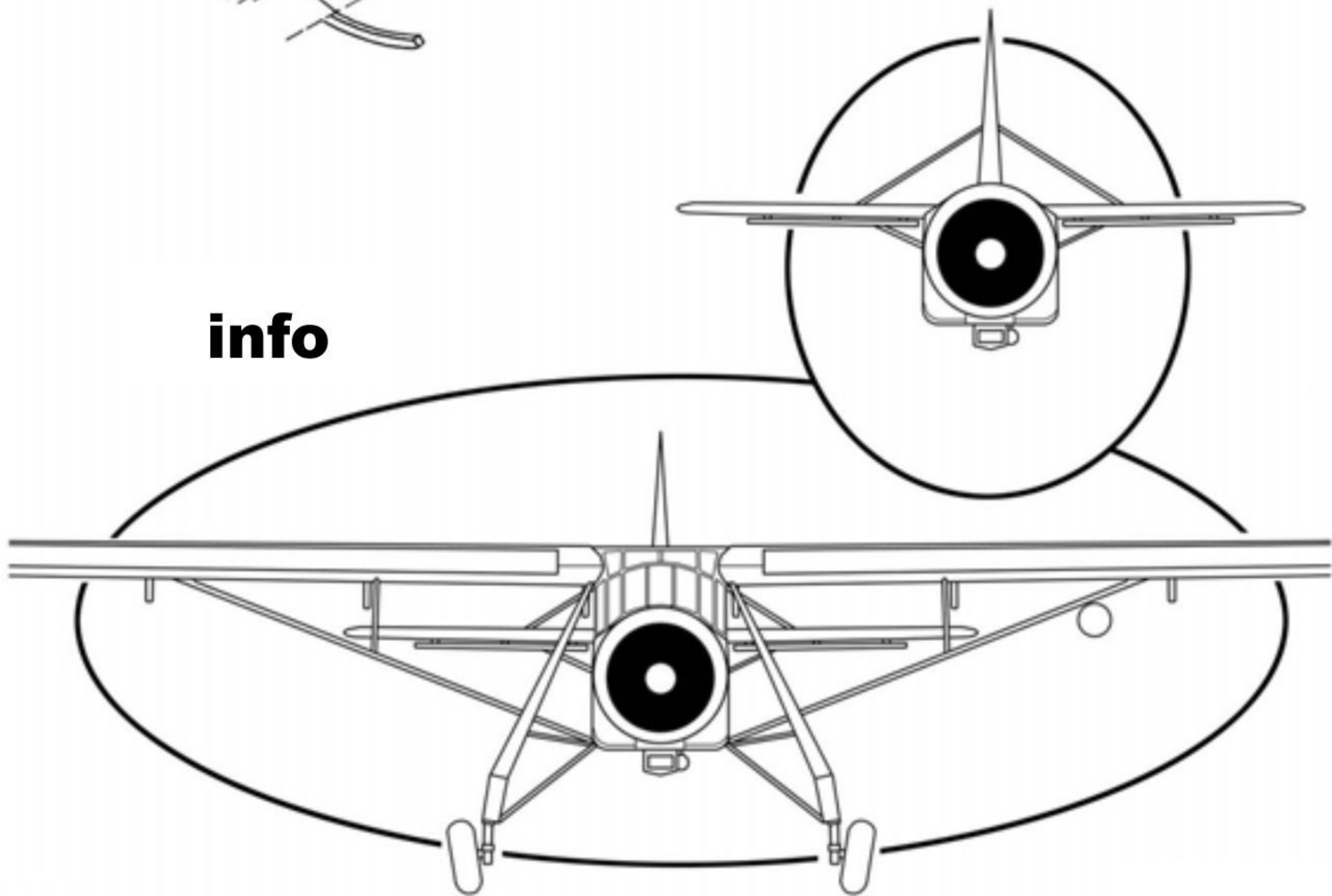

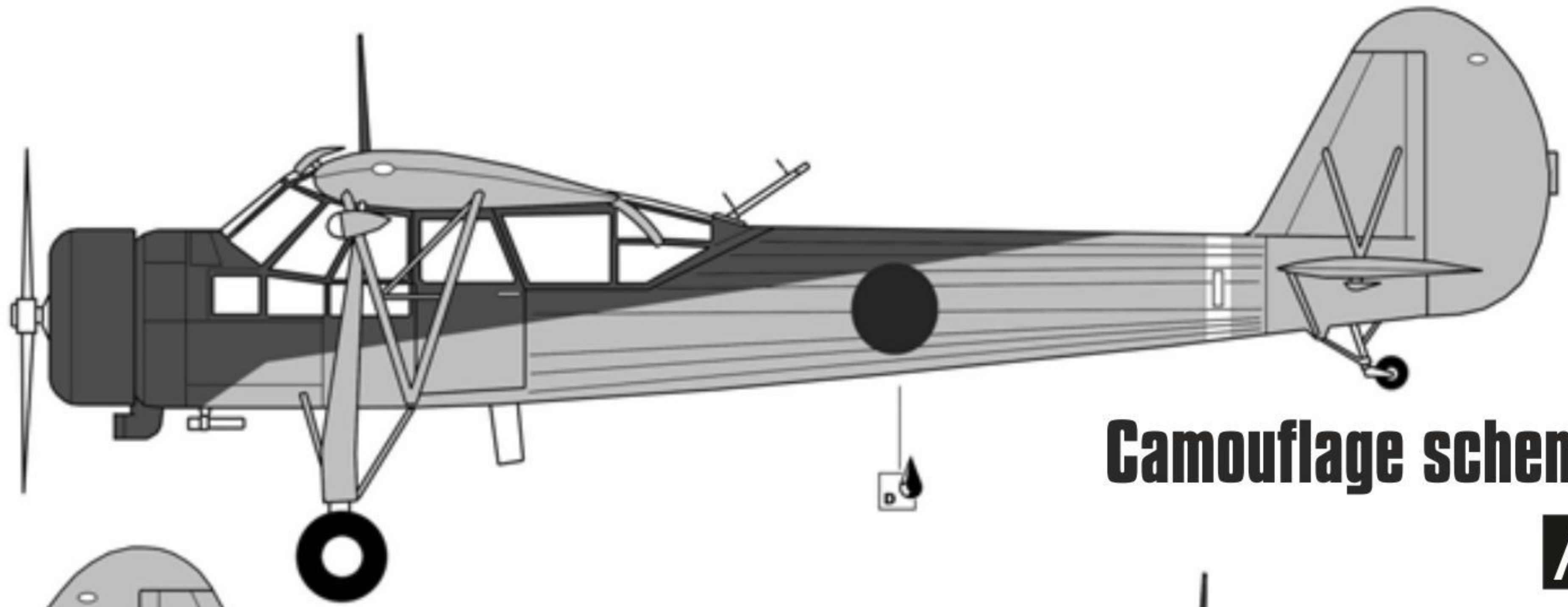

Camouflage scheme

A

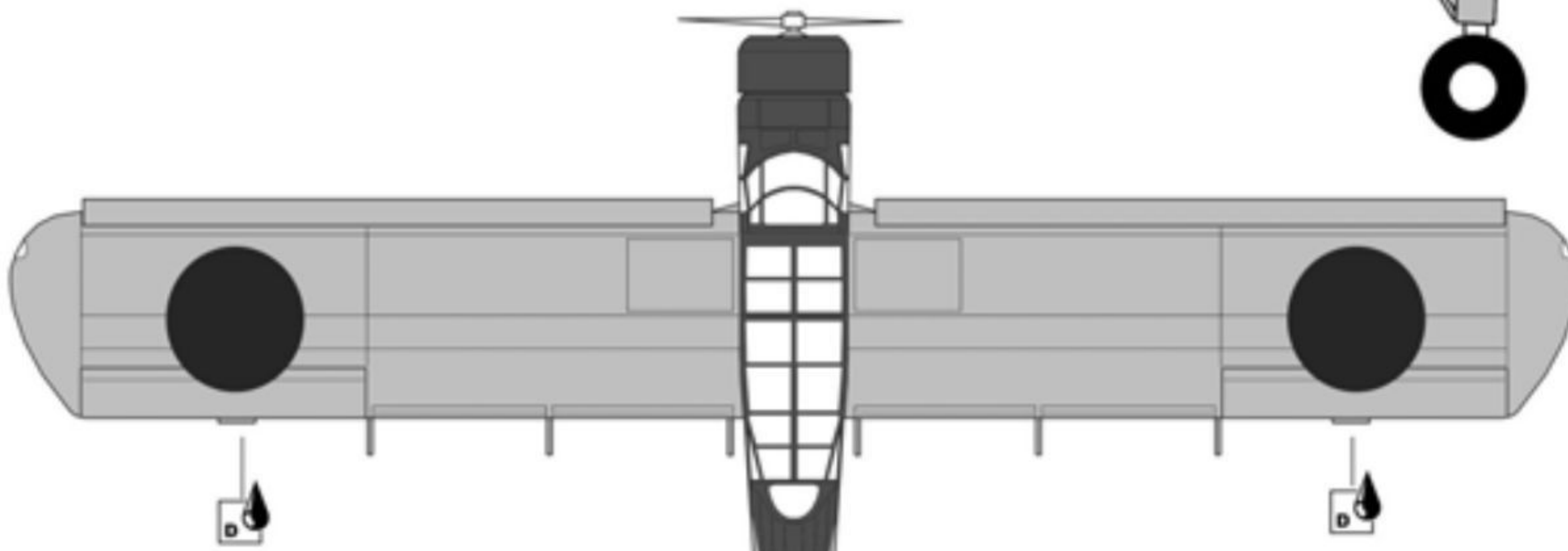
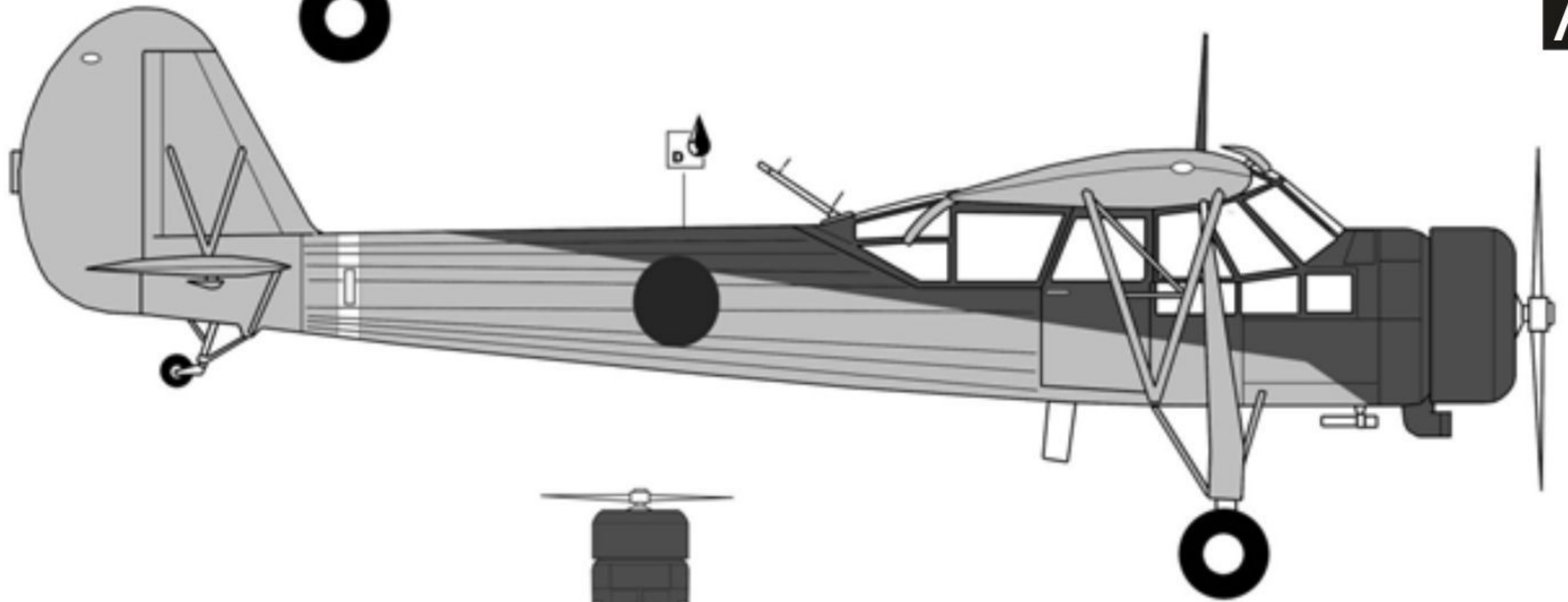

Army Type 3 Command Liaison Plane

*Imperial Japanese Army Air Force,
unidentified training unit, Japan, 1943*

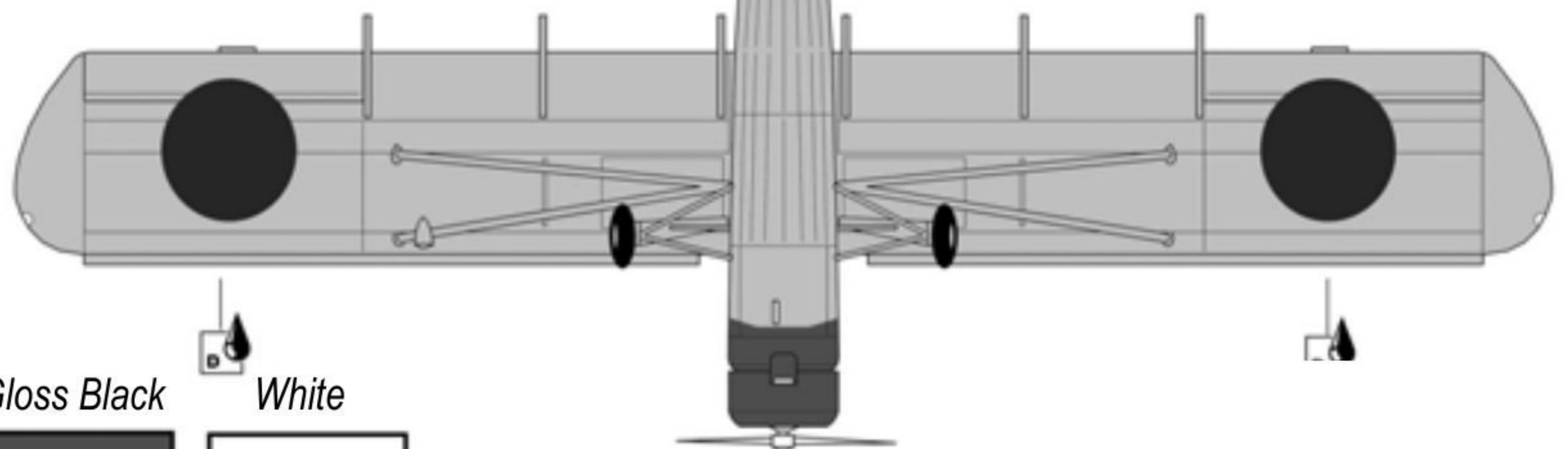
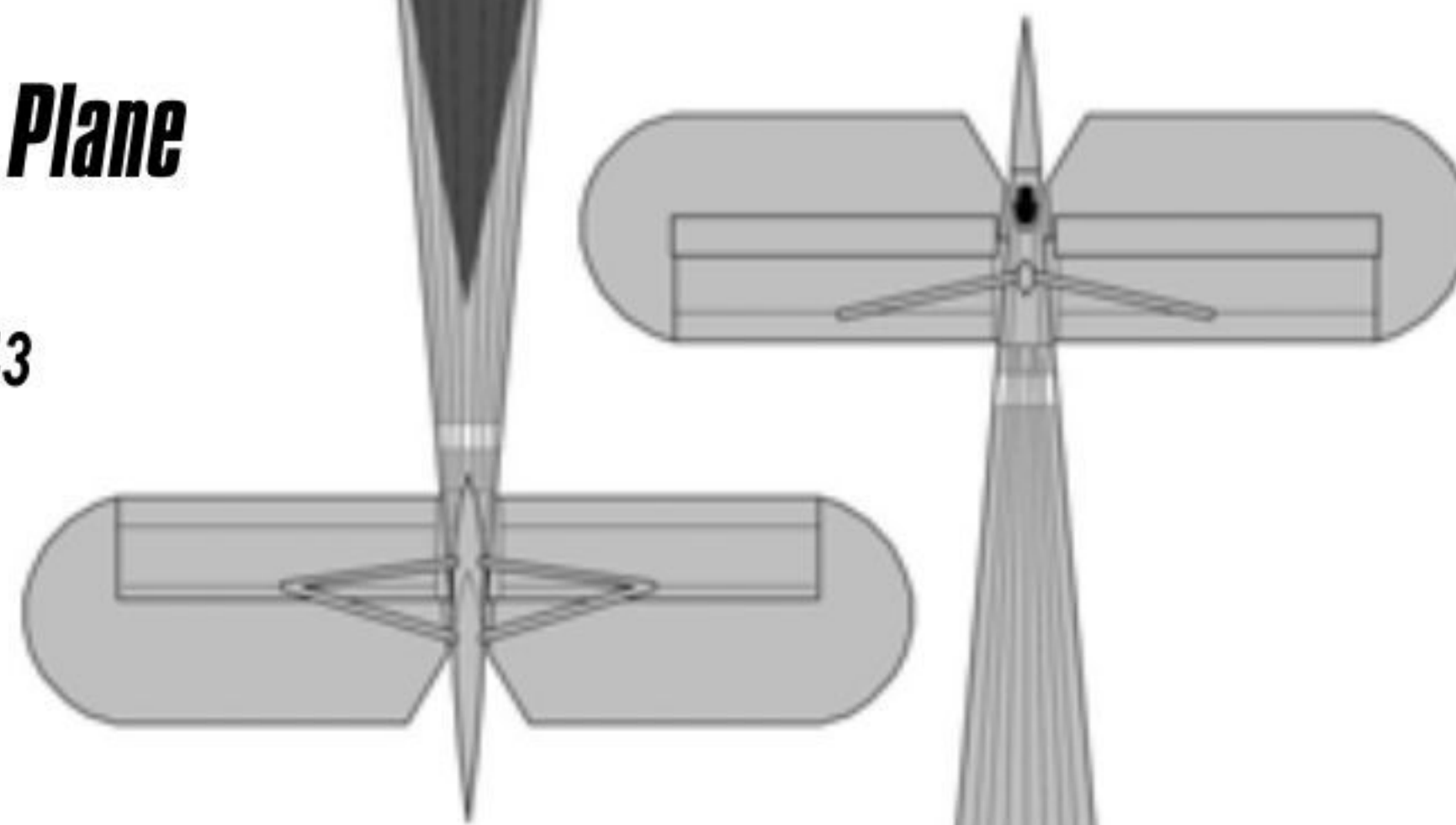

Training Orange Gloss Black White



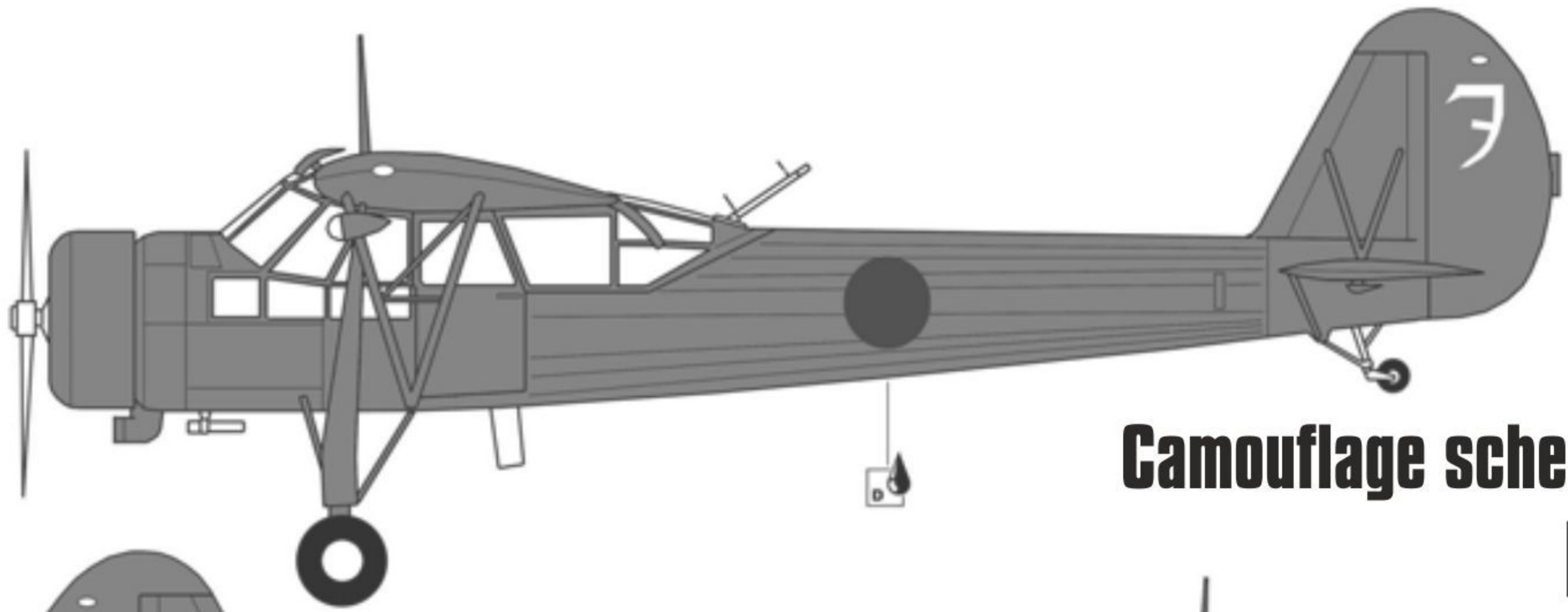

Camouflage scheme

B

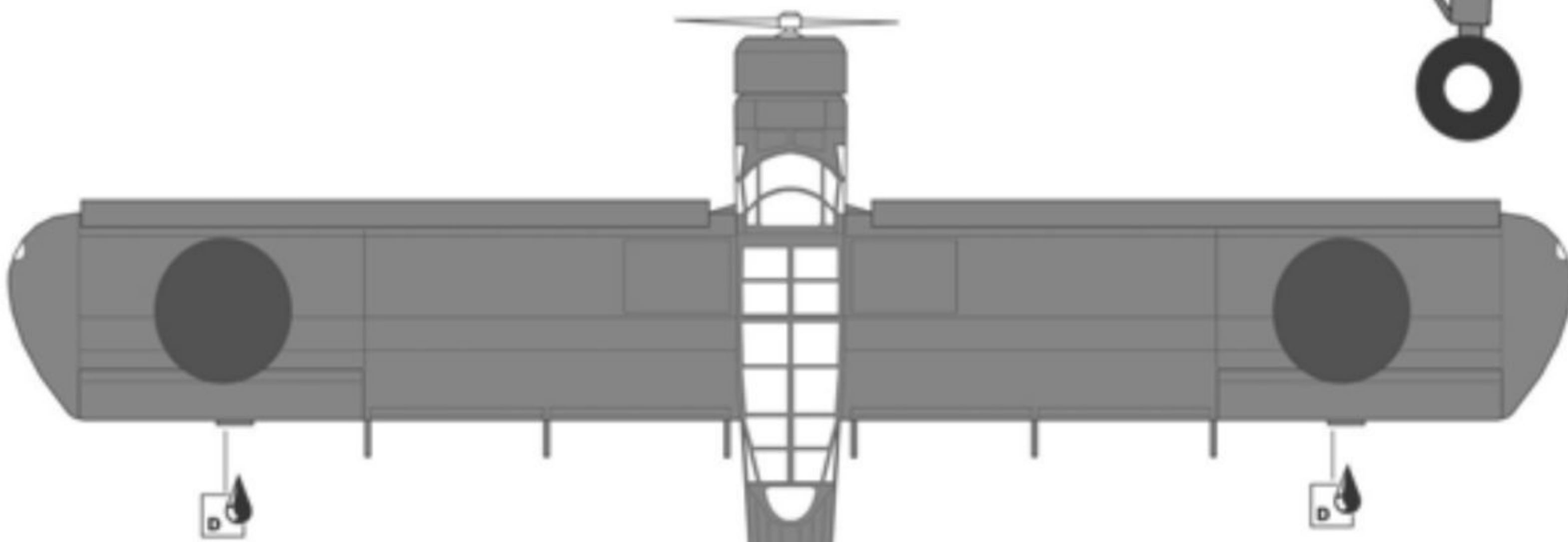
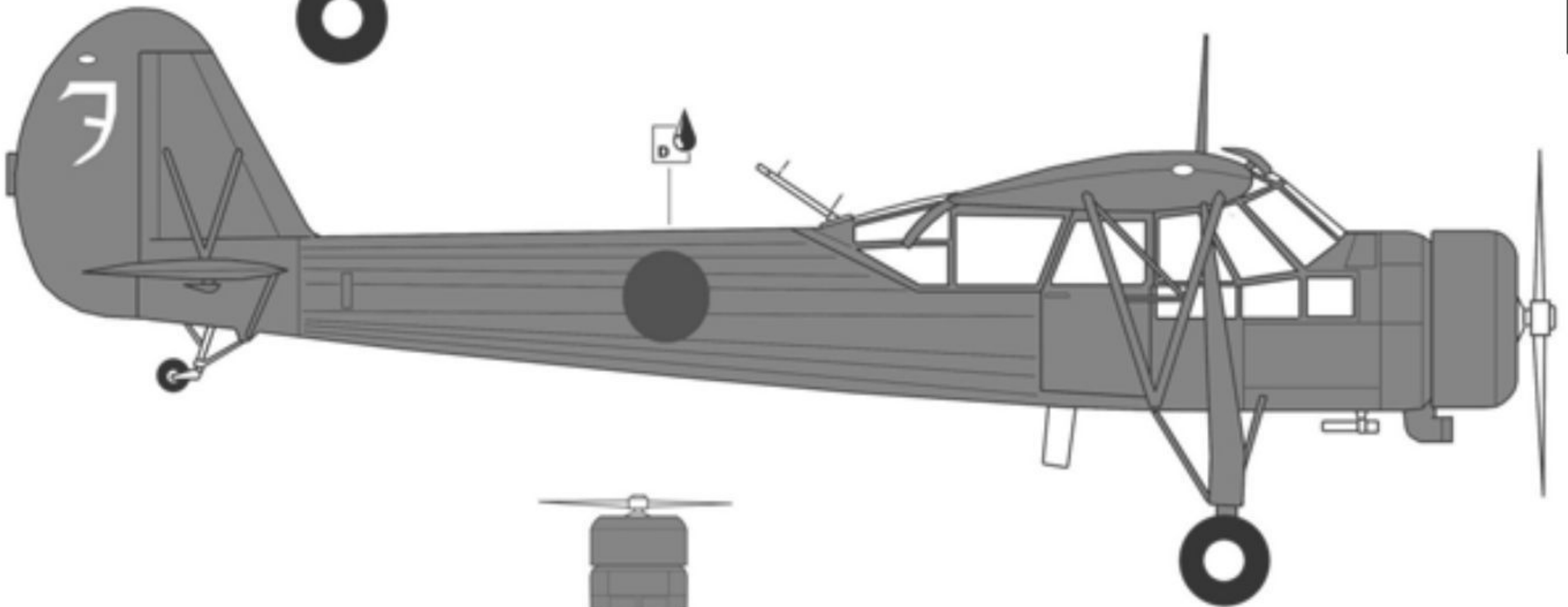

Army Type 3 Command Liaison Plane

*Imperial Japanese Army Air Force,
Japanese Army escort carrier Akitsu Maru,
Japan, 1944*

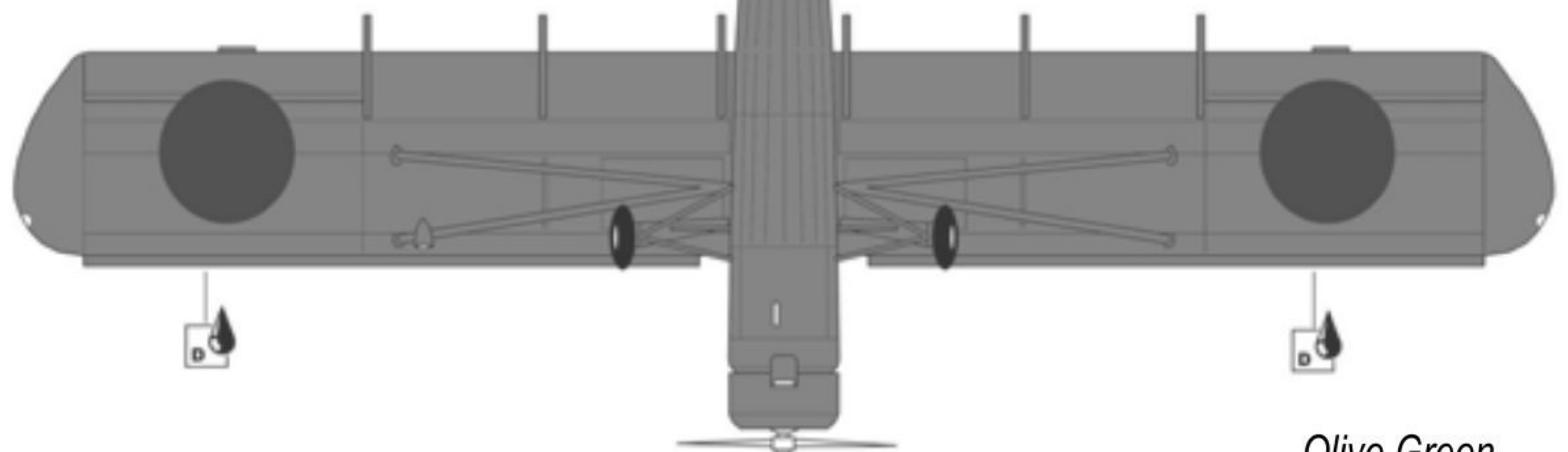
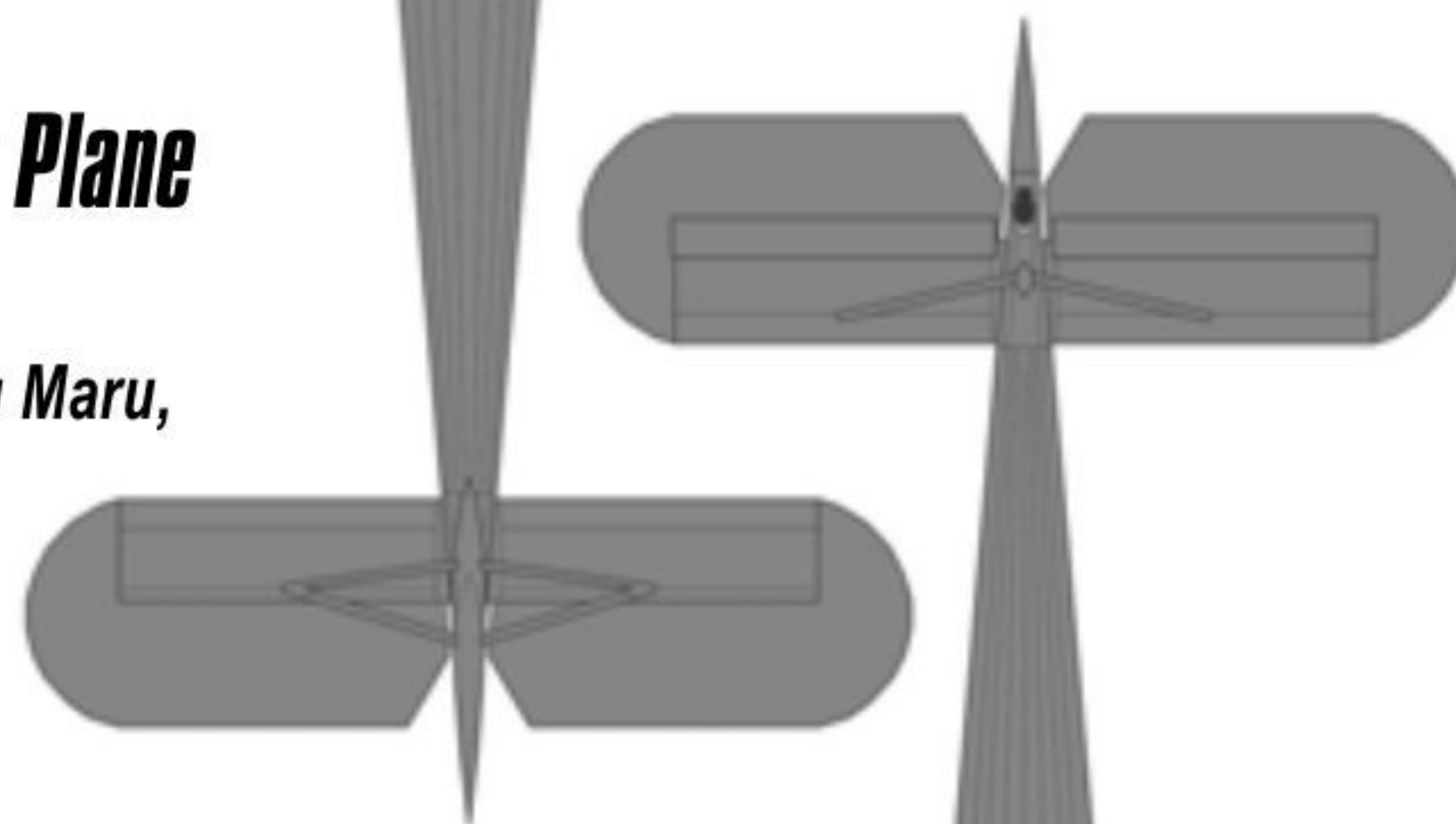

Olive Green



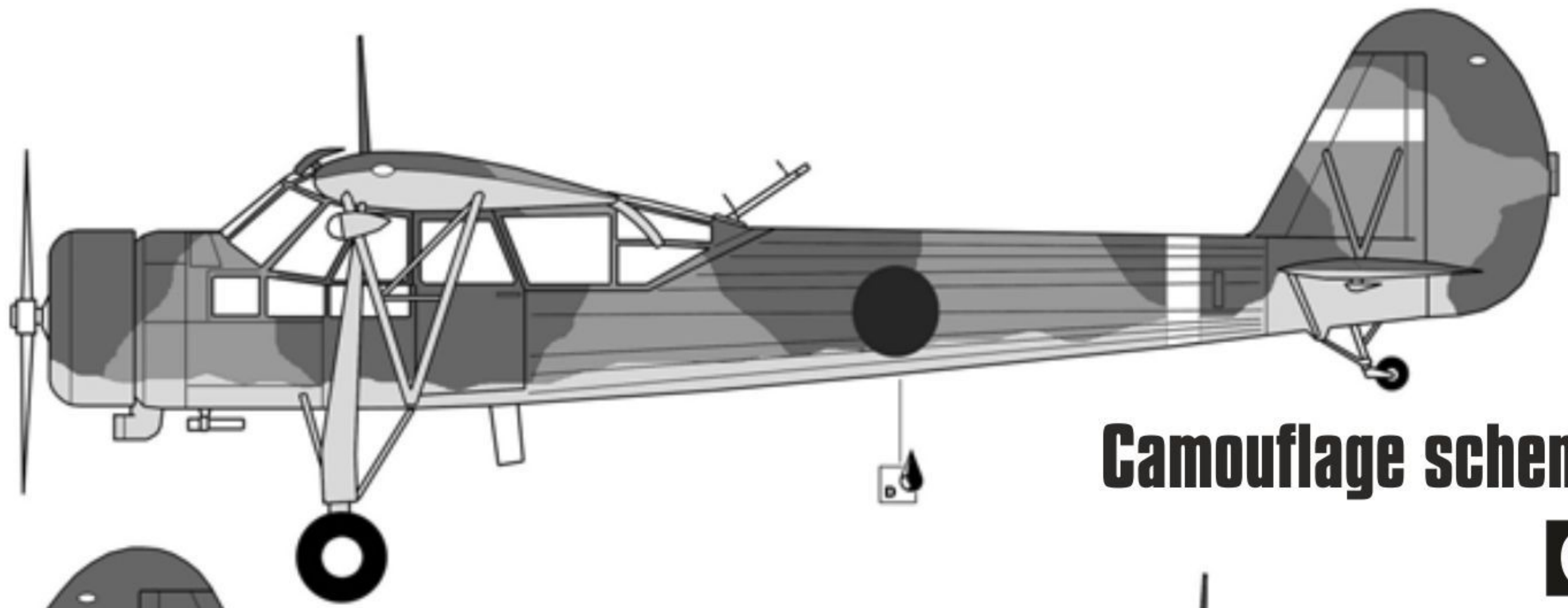

Camouflage scheme

C

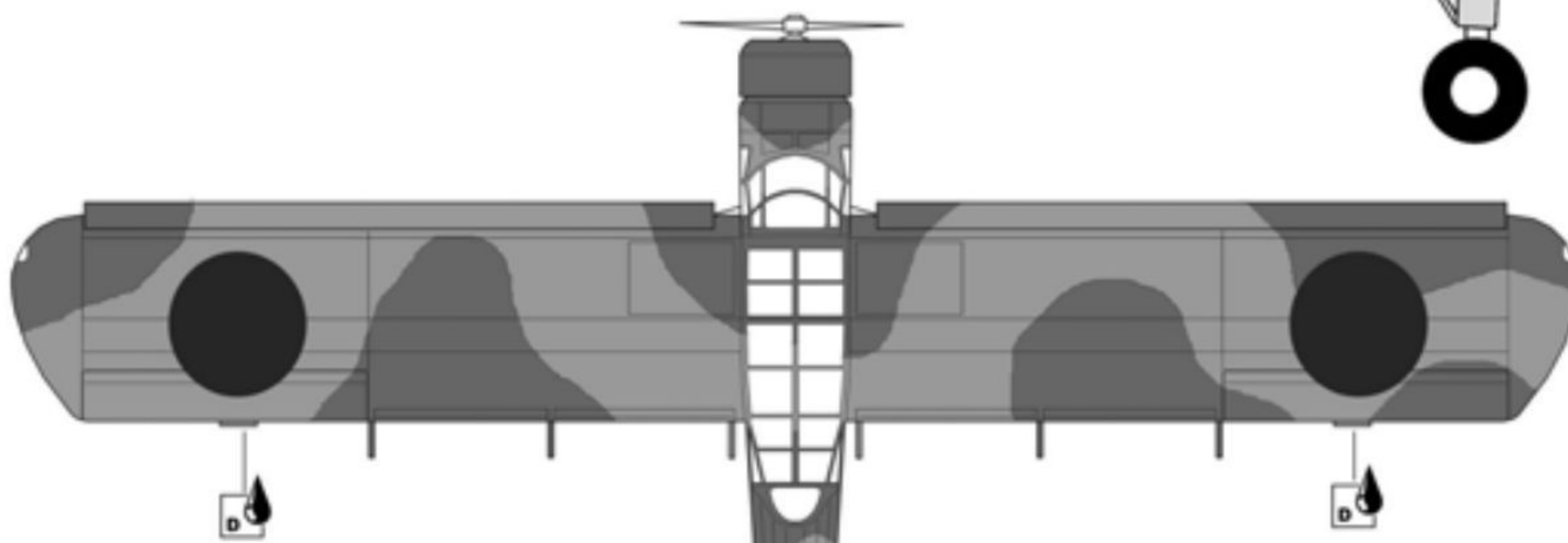
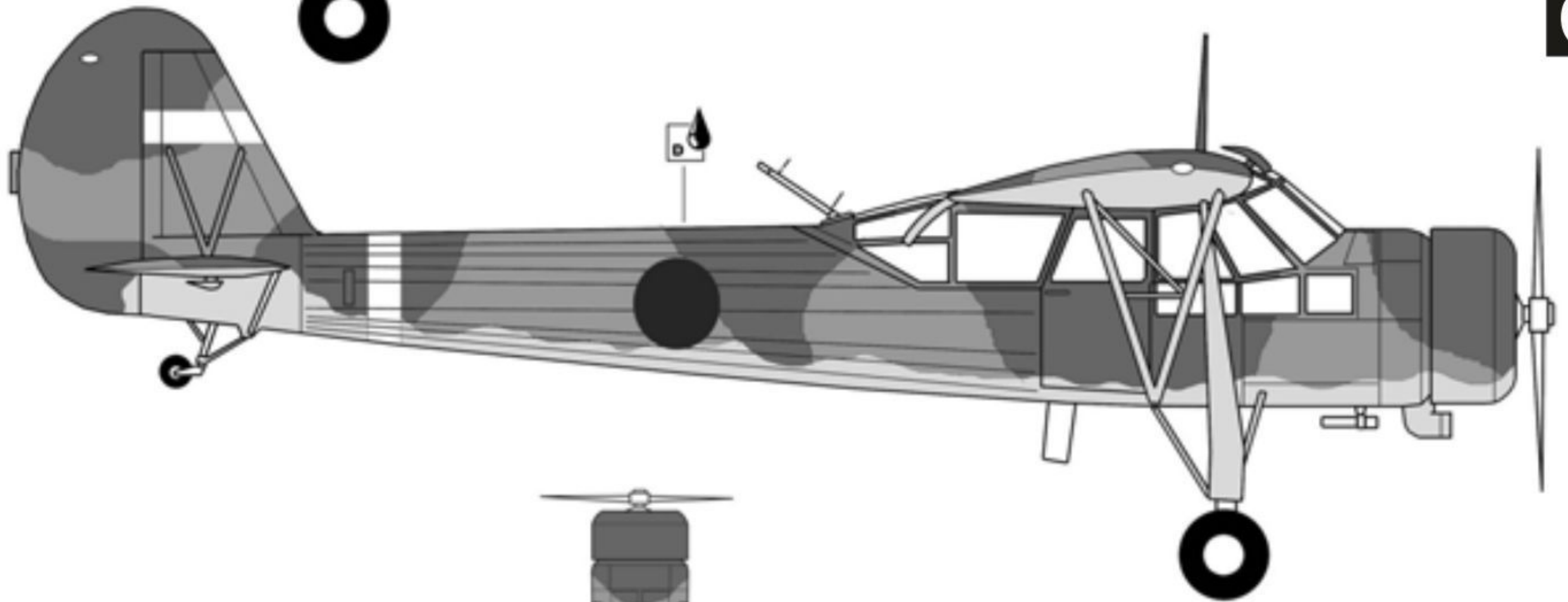

Army Type 3 Command Liaison Plane

*Imperial Japanese Army Air Force,
the Philippines, 1945*

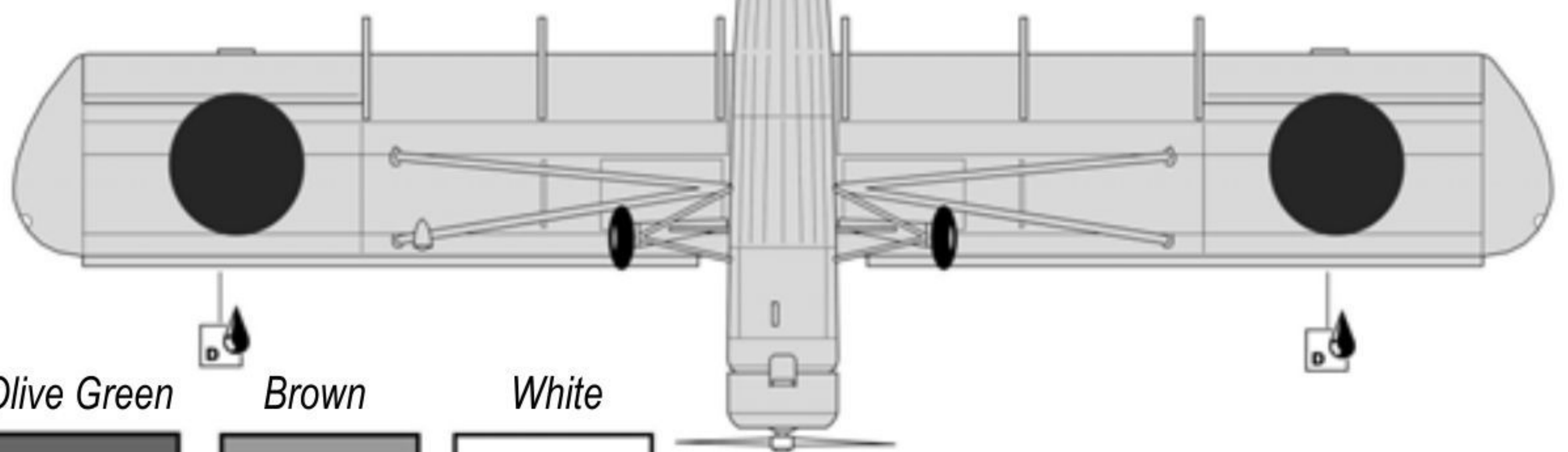
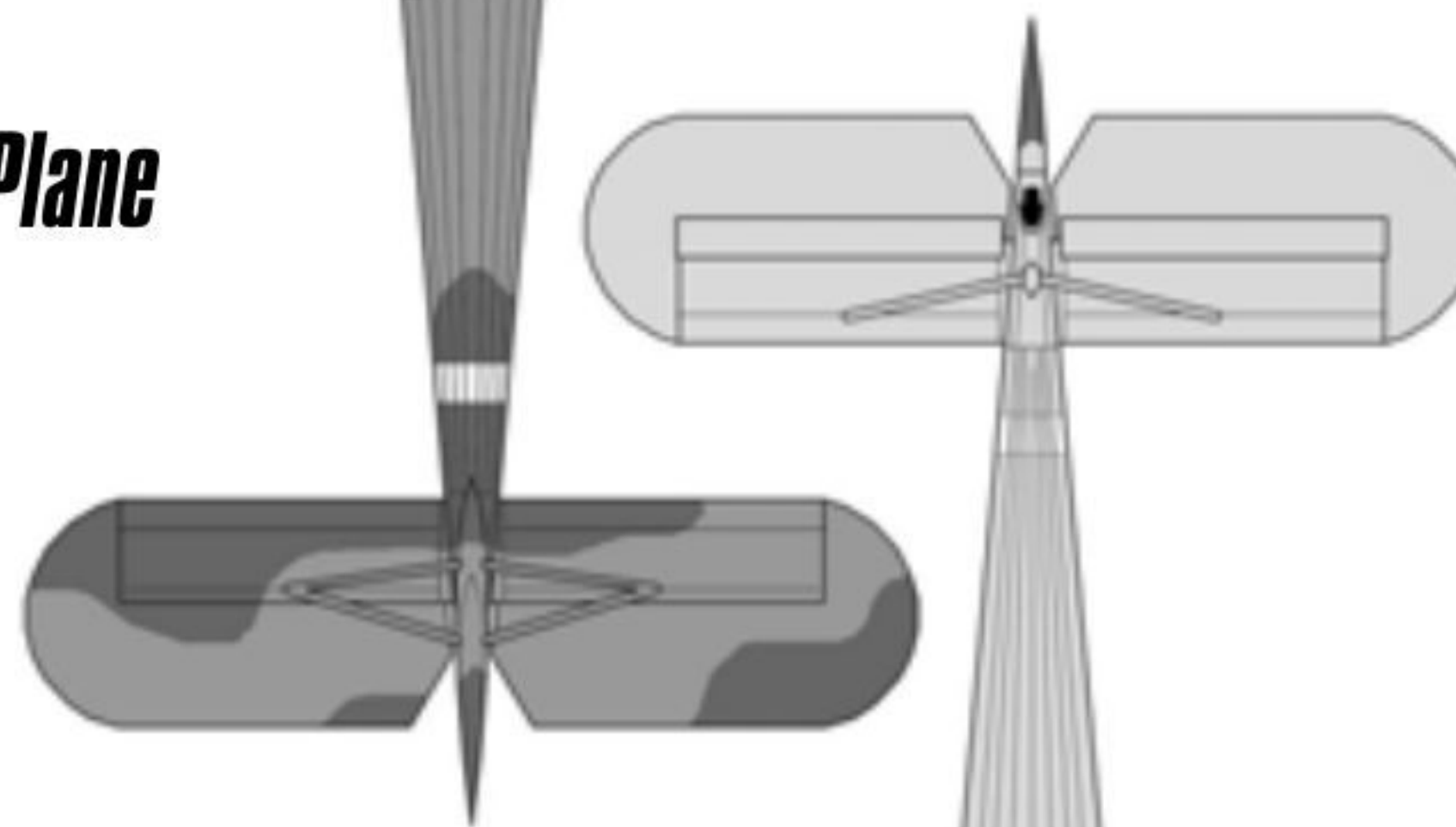

Light Grey

Olive Green

Brown

White

