

Heinkel He 219A-7

NIGHT FIGHTER



MKM14427
1/144 scale

MARK I Ltd.
PO Box 10
CZ-100 31 Prague 10 - Strašnice
Czech Republic
mark1@cmail.cz
www.4pluspublications.com

parts not
to be used

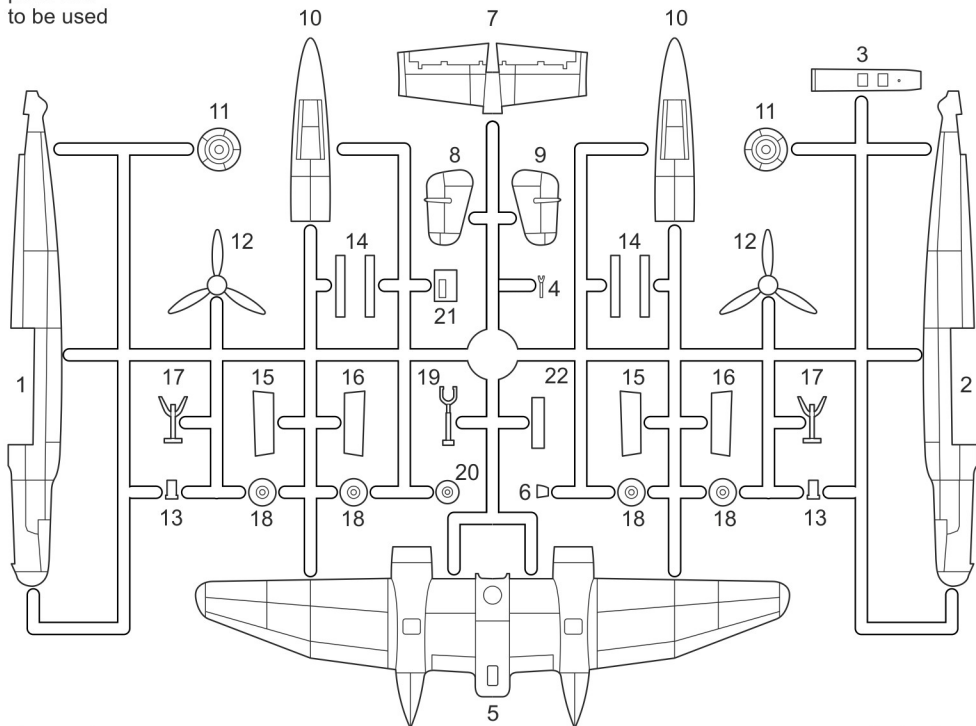

clear part



display base

PE parts

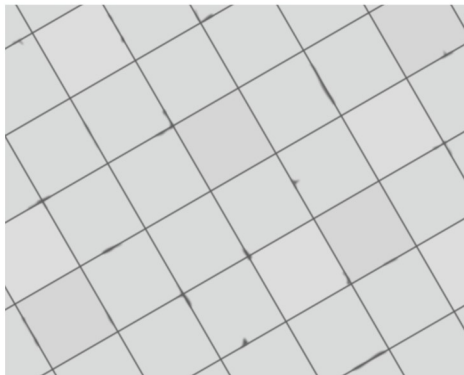
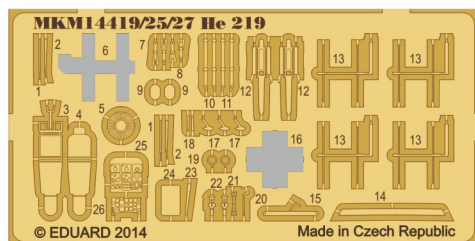

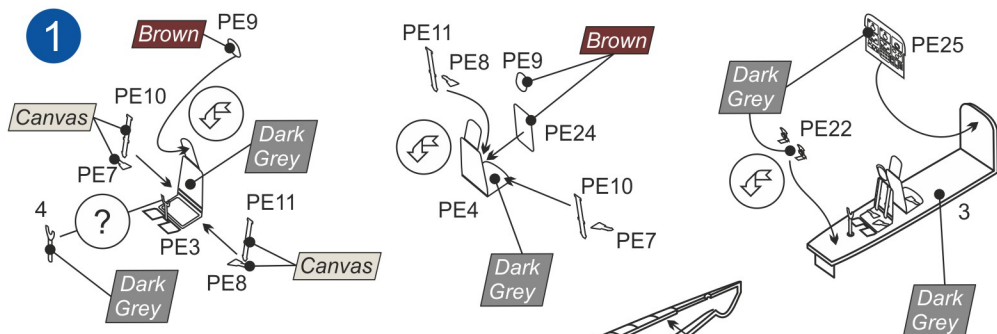

2

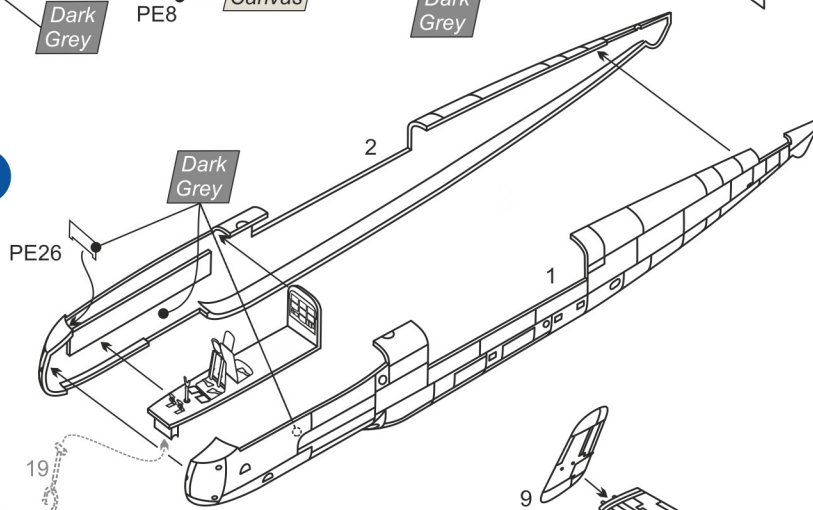

3

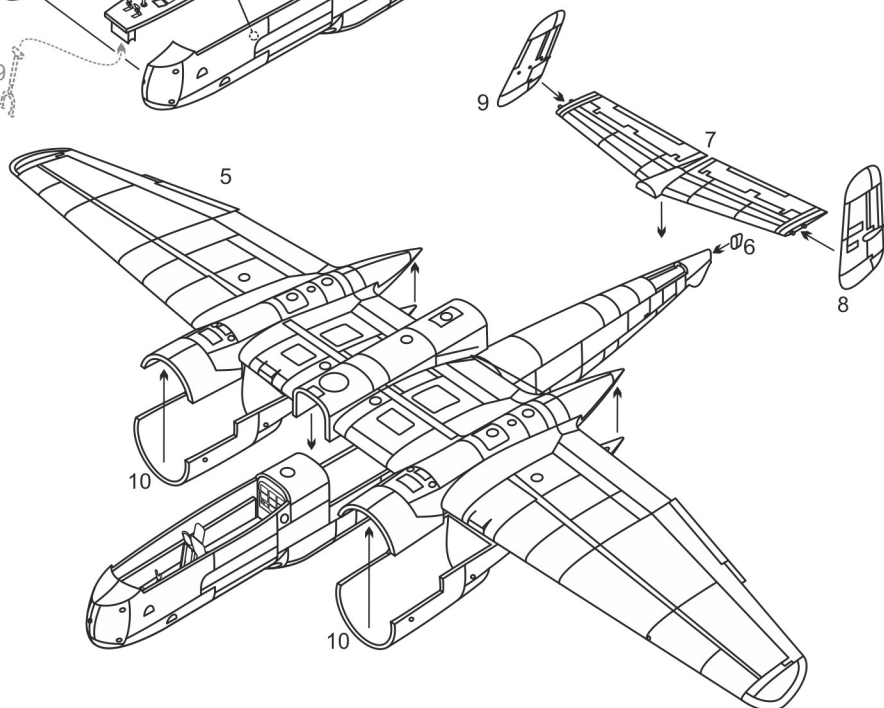

4

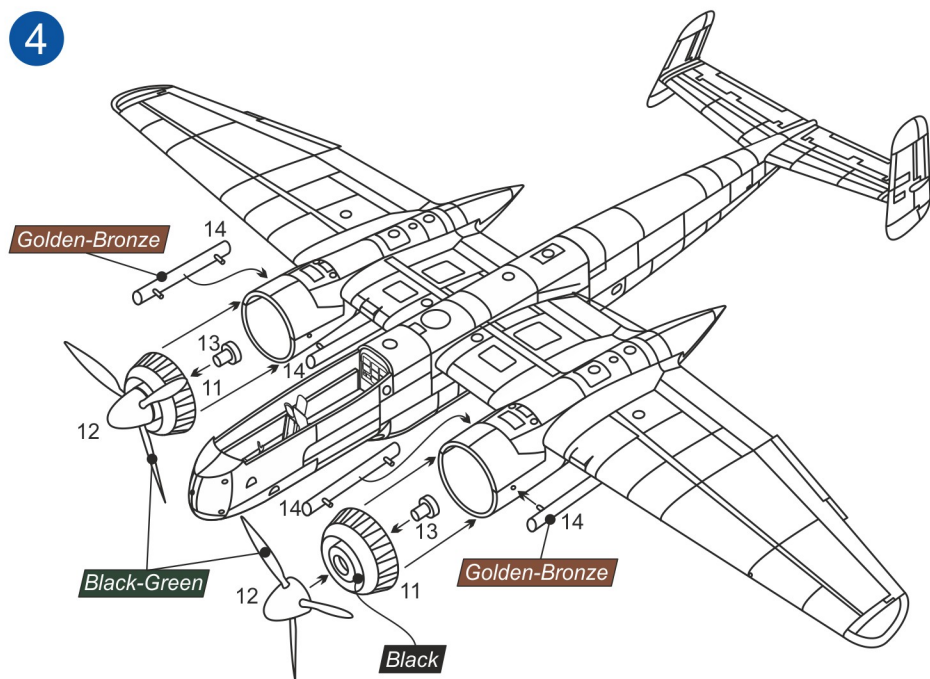

5

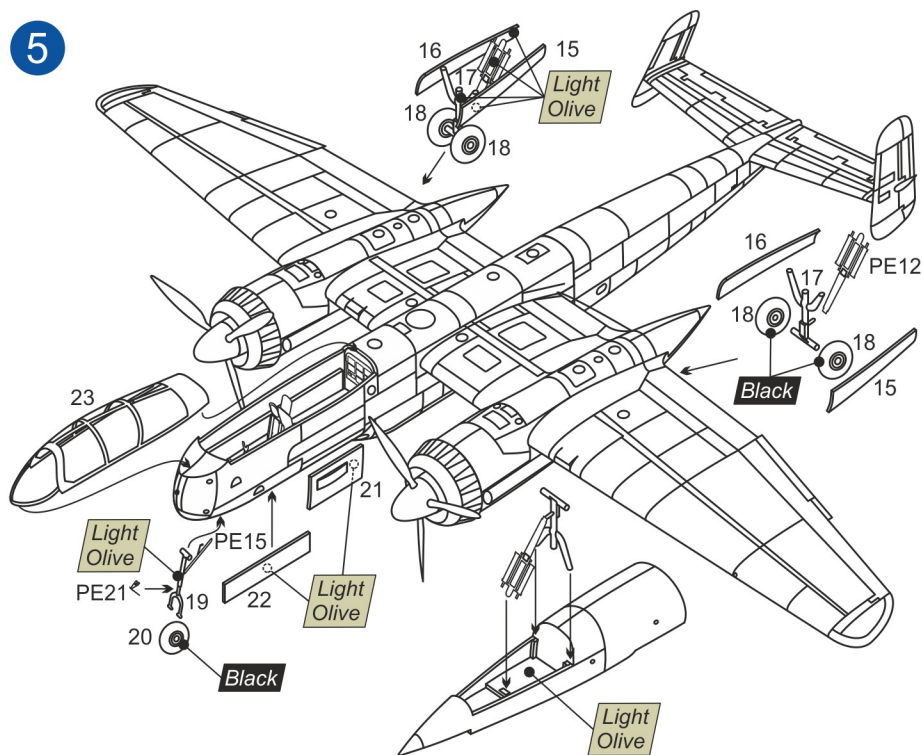

6

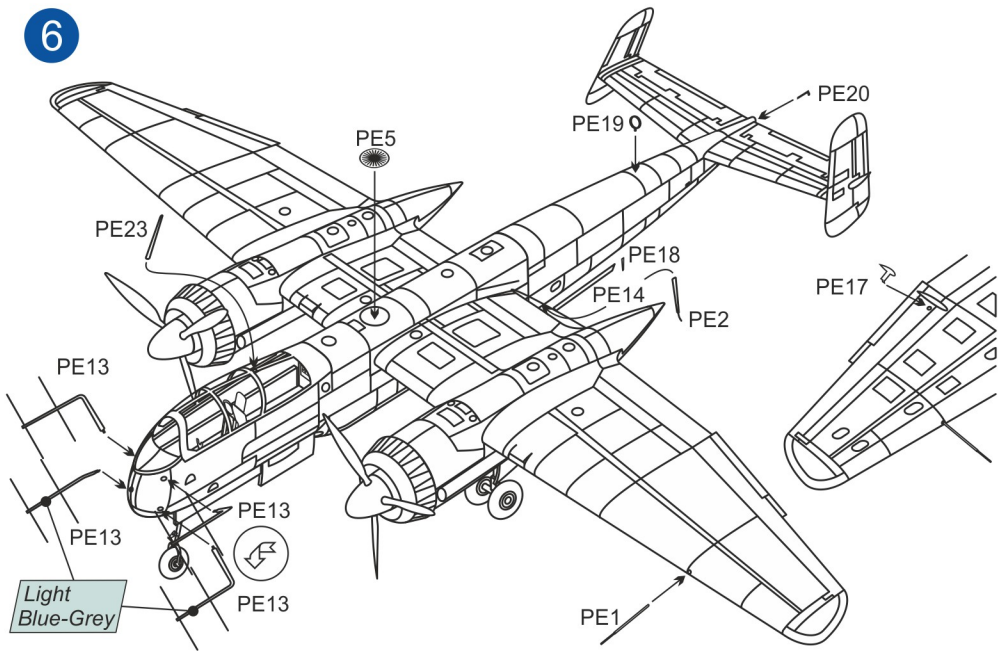

Note:

Due to difficulty in balancing of the model, it is either recommended to include balance weight inside the kit (to the fuselage nose and engines) or to glue it onto the display base supplied with this kit.

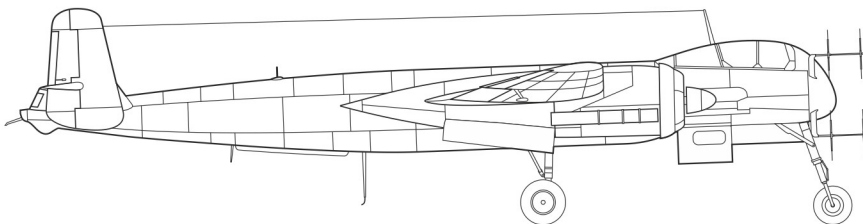
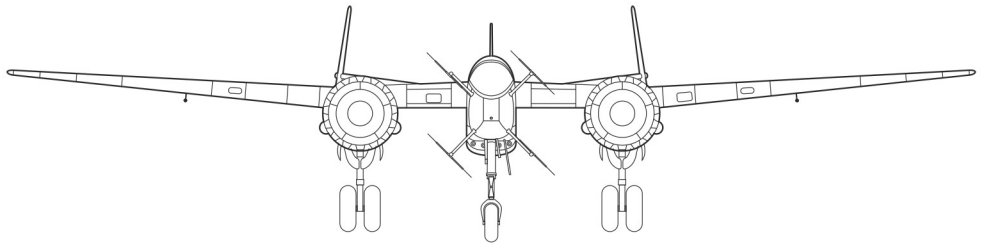

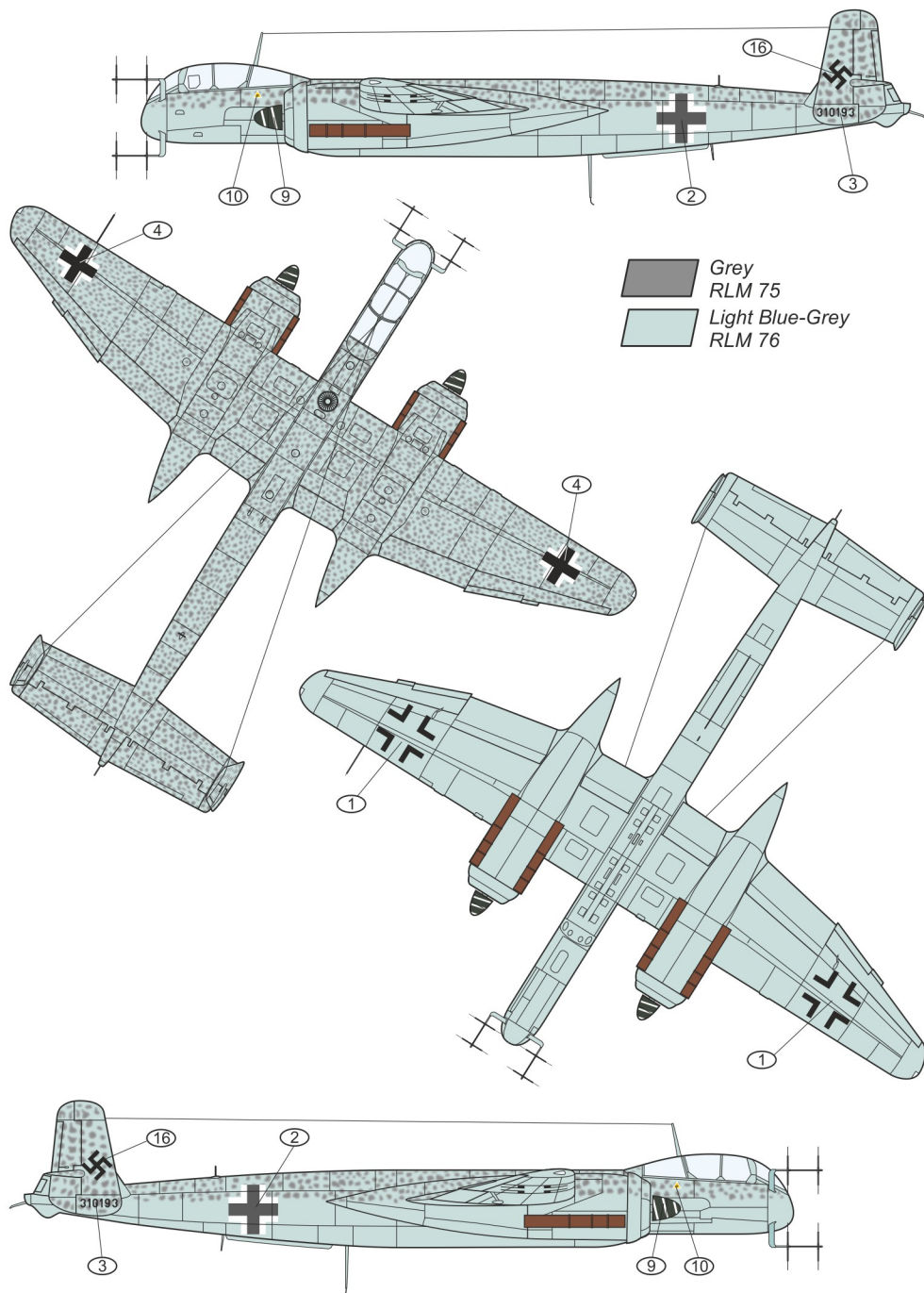

B

Heinkel He 219A-7, Black/Red G9+SK, 2./NJG 1, Luftwaffe, Münster-Handorf Air Base, Germany, Spring 1945

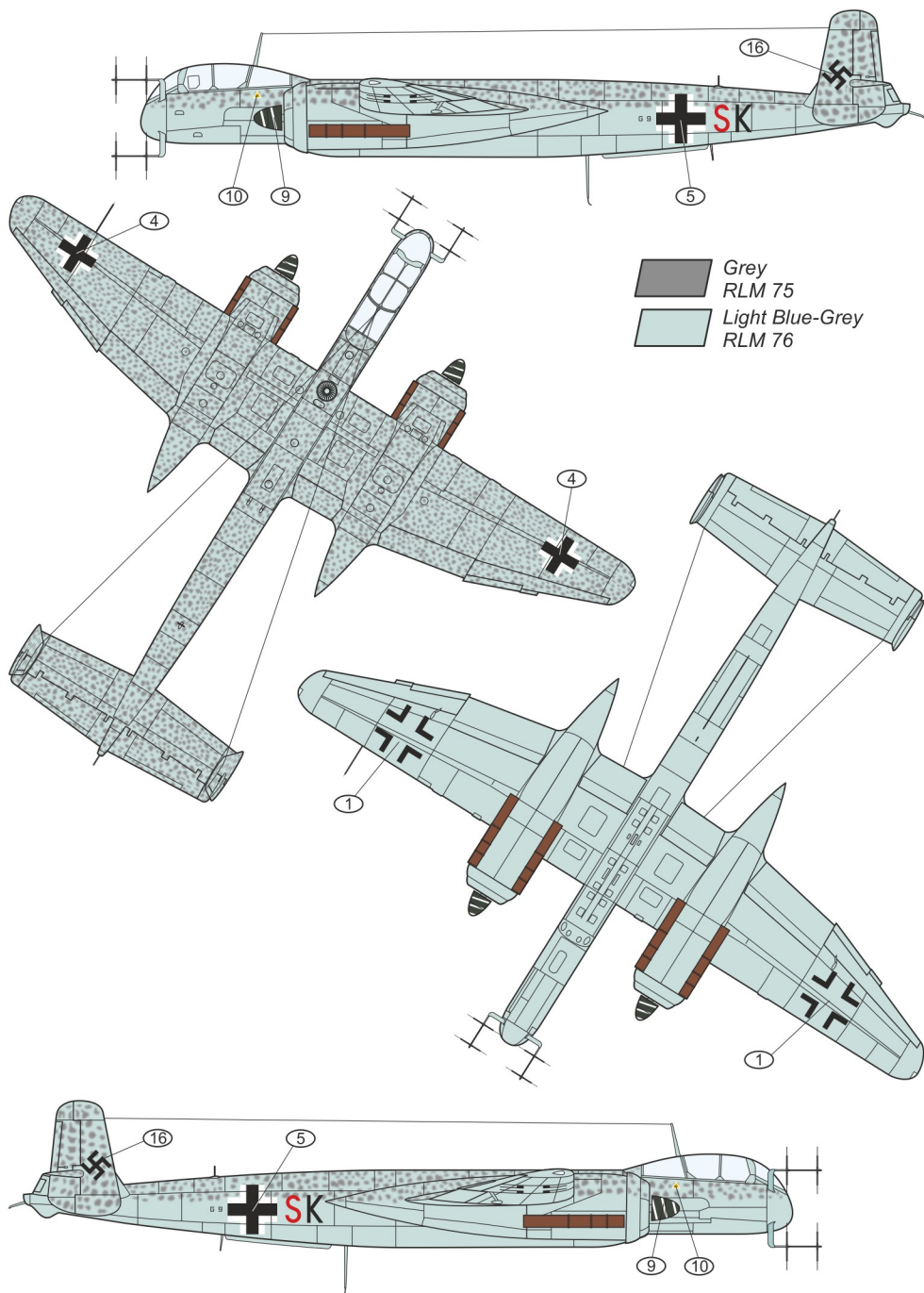



Heinkel He 219A-7, Black/Yellow D5+CL, 3./NJG 3, Luftwaffe, Grove Air Base, Denmark, April 1945

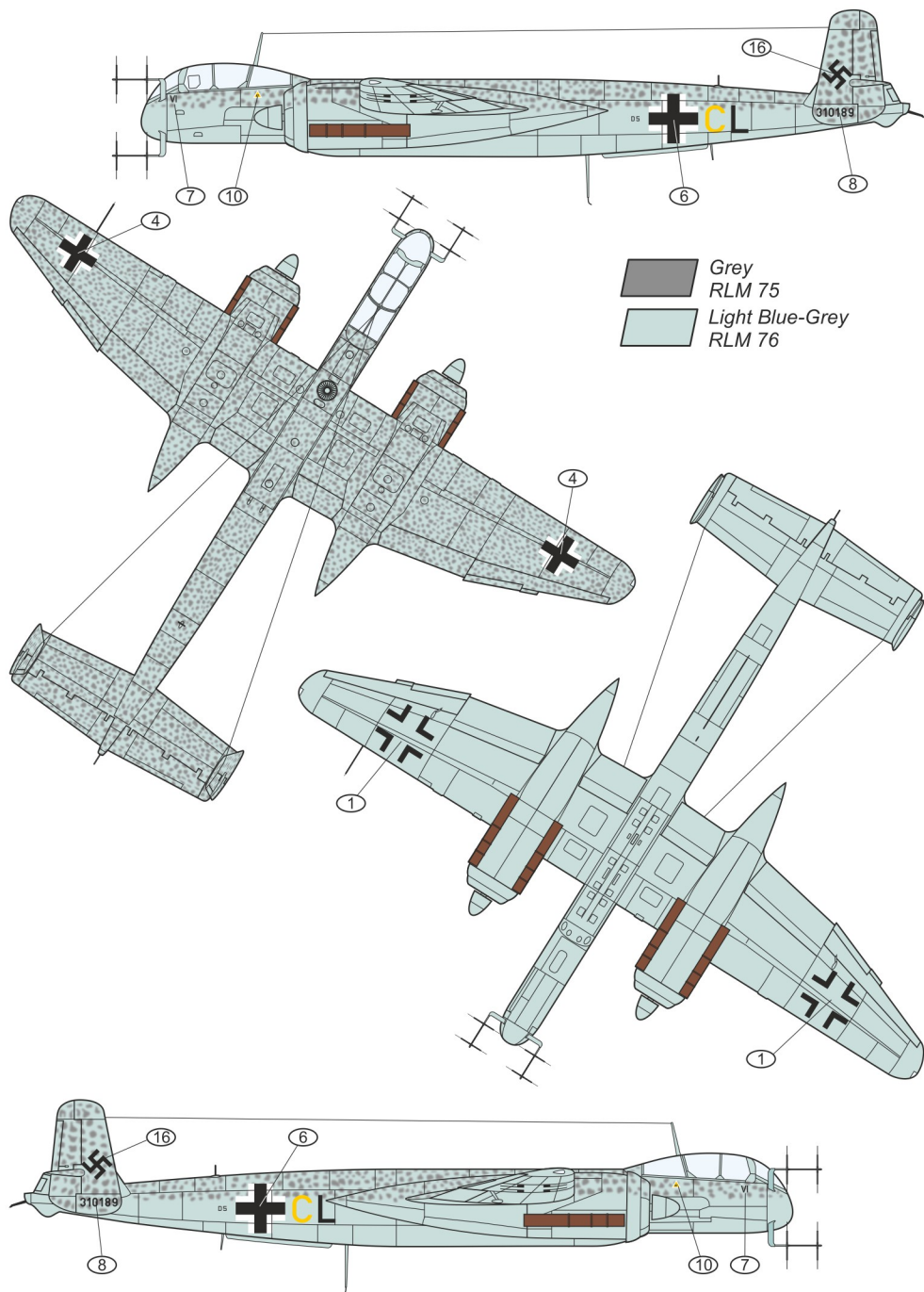



Heinkel He 219A-7, Air Ministry 22, Royal Aircraft Establishment, Farnborough, 1945-1946

