

# Avro Shackleton MR.3 "The Growler"

**MARK I Ltd.**

PO Box 10

CZ-100 31 Prague 10 - Strašnice

Czech Republic

[www.4pluspublications.com](http://www.4pluspublications.com)

## Colour notes:

Interior colour:

Interior Grey-Green BS283 (FS 34226)

Propellers to be painted in Black,  
with Red - White - Red tips

## Note:



To balance the model,  
add lead weight into the  
fuselage nose.

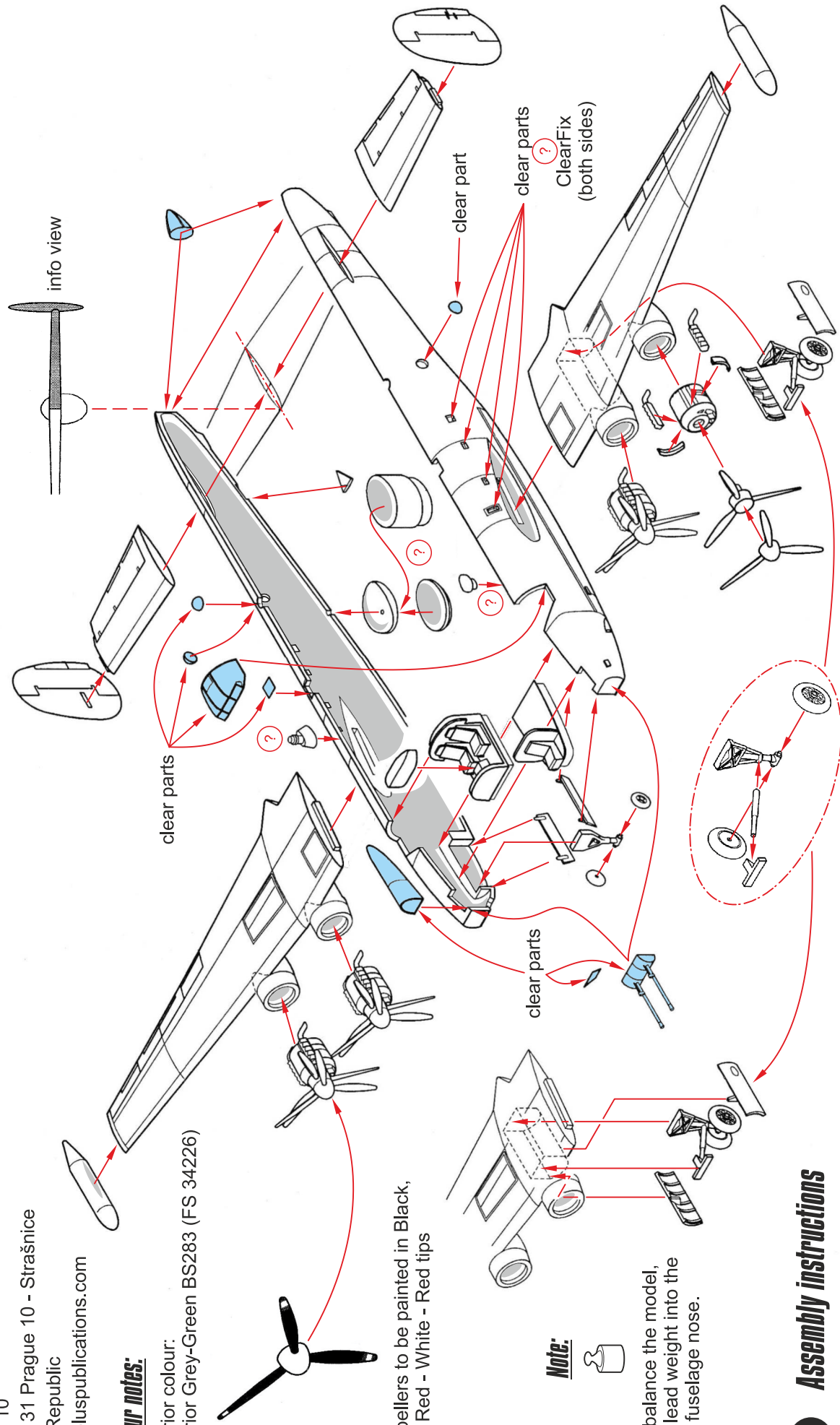

## 1 Assembly instructions

## 2 Breakdown of parts

resin parts



clear resin parts and foil

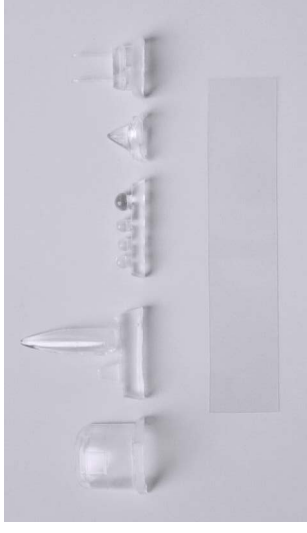

hardened resin parts



3

## Camouflage scheme

- A** Avro Shackleton MR.3, WR975/203-F  
No.203 Sq., RAF, Ballykelly Air Base  
County Londonderry, Northern Ireland, U.K., 1960

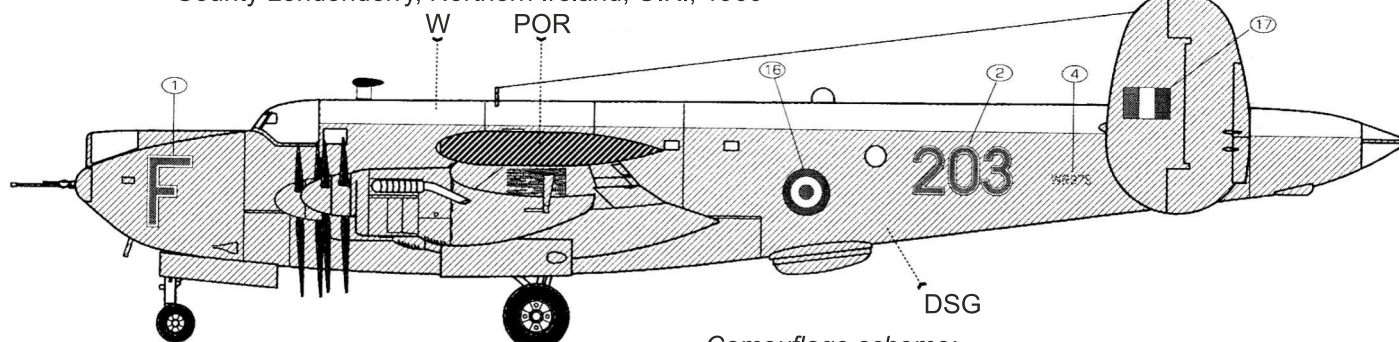

*Camouflage scheme:*  
Fuselage, wings and tailplanes Dark Sea Grey,  
upper part of the fuselage in White. Wingtip tanks in Red.

- B** Avro Shackleton MR.3, WR987/201-R  
No.201 Sq., RAF, St. Mawgan Air Base  
Cornwall, U.K., 1958

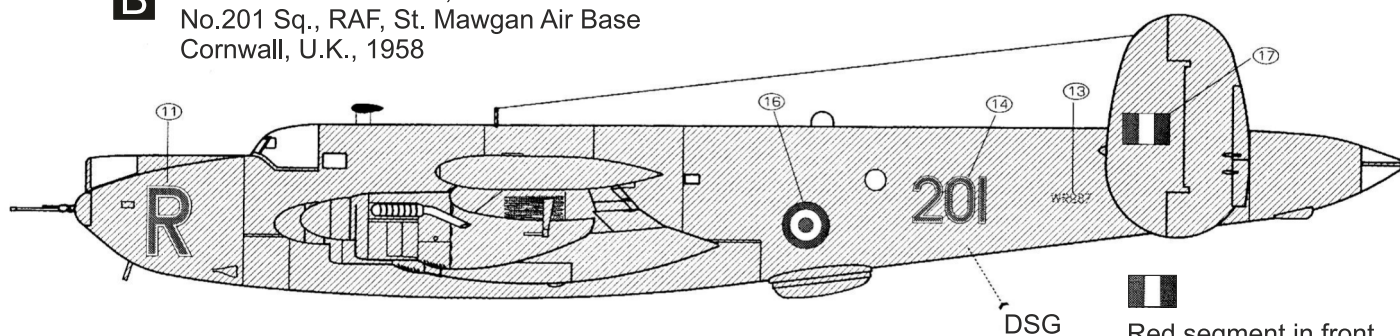

*Camouflage scheme:*  
Overall Dark Sea Grey.

- C** Avro Shackleton MR.3 (Phase II), XF730/120-B  
No.120 Sq., RAF, Kinloss Air Base  
Moray, Scotland, U.K., 1965

*Camouflage scheme:*  
Fuselage, wings and tailplanes Dark Sea Grey,  
Black anti-glare panel, upper part of the fuselage  
in White. Wingtip tanks in Red.  
Spinner segments in Green, Blue and White.

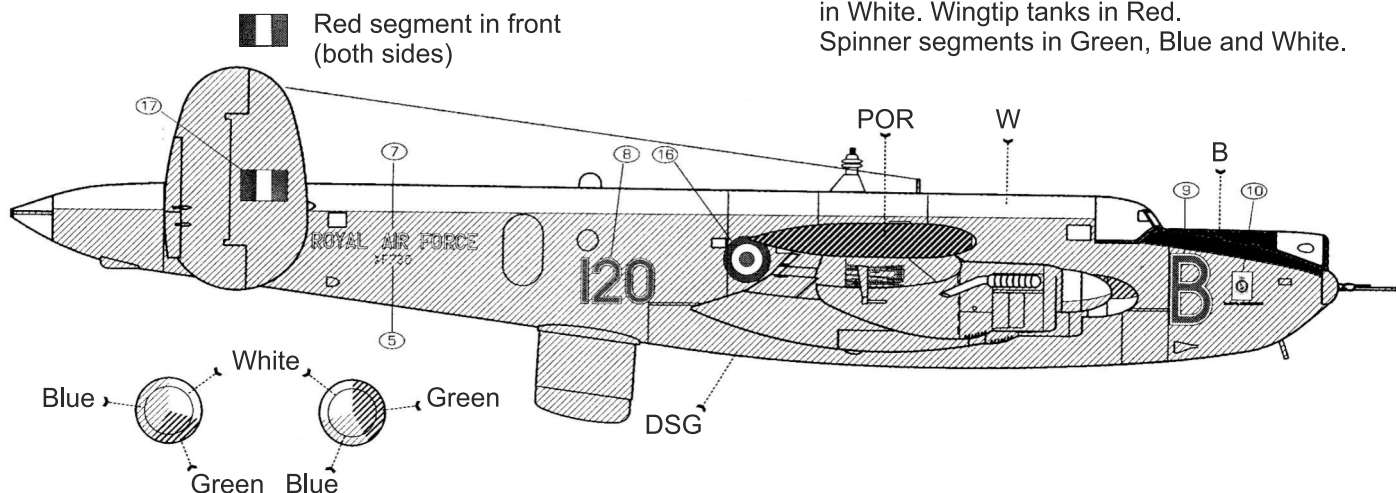

spinners  
(both sides identical)

### Colour code:

DSG = Dark Sea Grey  
W = White  
B = Black  
POR = Post Office Red

### Colour note:

Dark Sea Grey BS638 (FS 26173)  
Post Office Red/Cherry Red BS538  
(rough equivalent FS 11136)



### Camouflage scheme

PRU



Orange segment in front  
(both sides)

Upper surfaces of wings, tailplanes and fuselage Dark Sea Grey. Fuselage and tailplane sides, wingtip tanks and lower surfaces PRU Blue.

Orange segment in front  
(both sides)

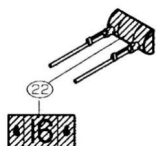

v

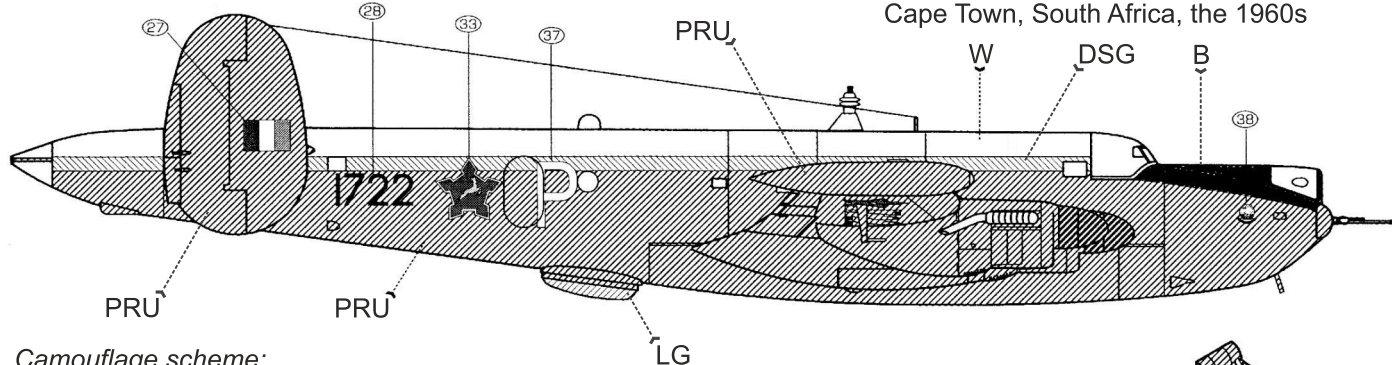

Upper surfaces of wings and tailplanes Dark Sea Grey. Black anti-glare panel. Fuselage and tailplane sides, lower surfaces and wingtip tanks PRU Blue. Fuselage top in White, with a band of Dark Sea Grey. Spinners in Red, radome in Light Grey.

Upper surfaces of wings and tailplanes, and upper half of wingtip tanks Dark Sea Grey, Black anti-glare panel. Fuselage and tailplane sides, lower surfaces and lower half of wingtip tanks PRU Blue. Fuselage top in White.  
Spinner front parts in Red, radome in Light Grey.

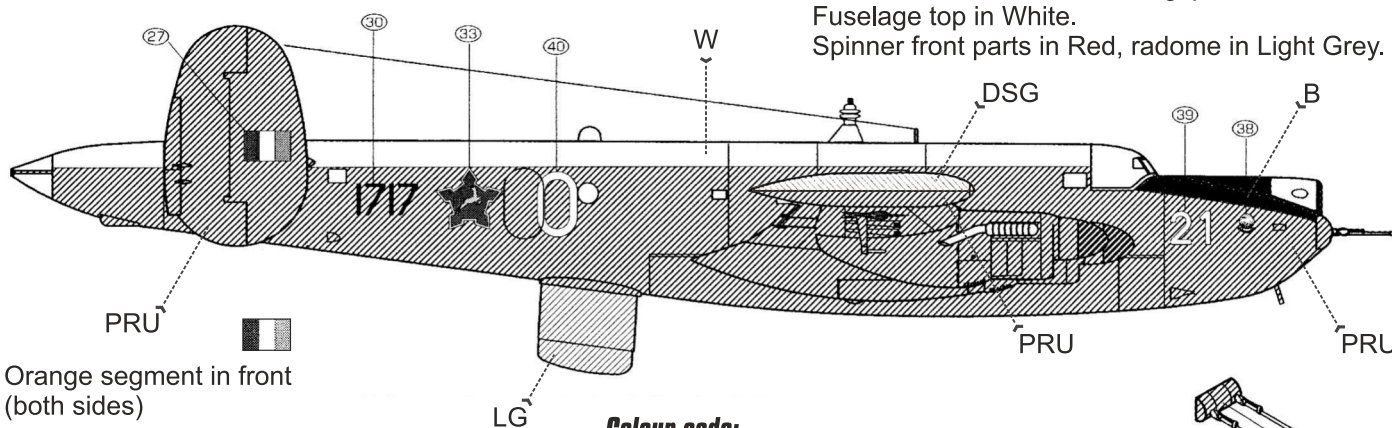

Orange segment in front  
(both sides)

**Colour code:**

DSG = Dark Sea Grey  
PRU = PRU Blue  
W = White  
B = Black  
LG = Light Grey

**Colour note:**

Dark Sea Grey BS638 (FS 26173)  
PRU Blue Bs636 (FS 35164)



**3**  
**A**  
**B**  
**C**

# *Camouflage scheme*

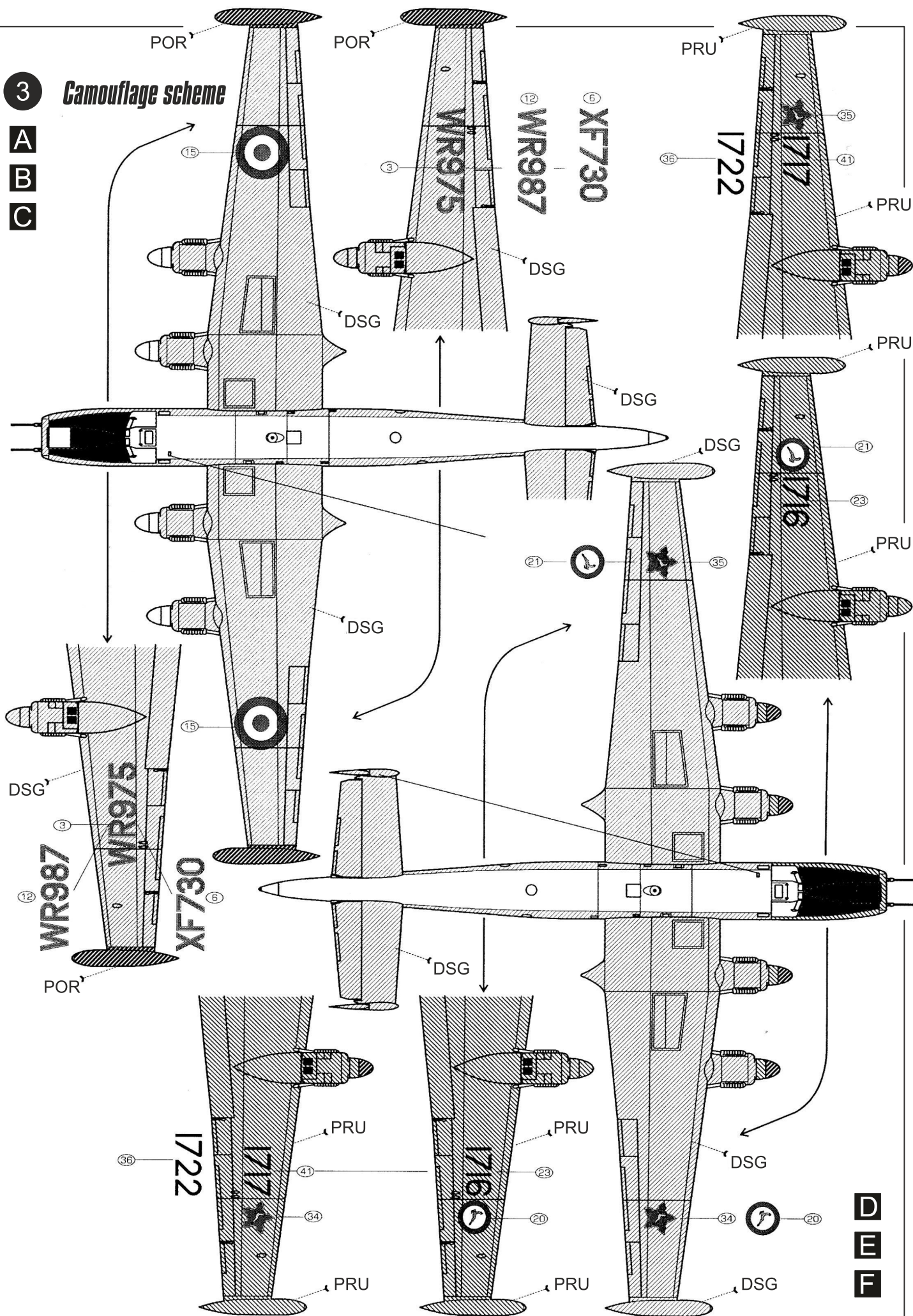

**D**  
**E**  
**F**

